

Quick Installation Guide



Краткое руководство по установке

Guía de Instalación Rápida

Guia de Instalação Rápida

Petunjuk Pemasangan Cepat

DIR-506L
Pocket Cloud Router

Version 1.20 | August 23, 2012

Package Contents



Pocket Cloud Router



USB Cable (for power and charging battery only)



Rechargeable Battery

Insert and Charge the Battery

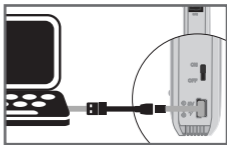
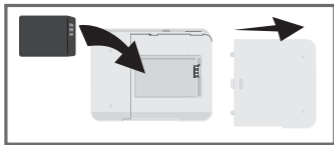

1. The battery must be installed for the device to operate. Slide off the cover and insert the battery. Make sure the gold contacts align with the gold terminals. Slide the cover back on.
2. Connect the USB cable to the DIR-506L and then connect to a USB port on your computer.

Note: Charge the device using the USB cable for at least 4 hours or until it is fully charged before usage.

SharePort Mobile - Sharing Made Easy

Stream movies, music, photos, and documents from a USB drive plugged into the DIR-506L right to your iPhone, iPad, or Android device, or to a PC; you don't even need to be connected to the Internet!

SharePort Mobile transforms any USB drive into your own personal shared file space that you can access with all your devices.

Supported File Formats for iOS and Android:

- Video: .mp4, .mov
- Music: .mp3, .wav
- Image: .bmp, .gif, .jpg, .png
- Document: .doc, .xls, .ppt, .pdf, .pages, .numbers, .key, .txt, .html, .ref

Download the SharePort Mobile App

Use a barcode scanner app such as **Bakodo** or **RedLaser** on your iOS or Android device to scan the corresponding code for your device below. If you do not have a scanning app, just search for **SharePort Mobile** in the App Store or Google Play. Please make sure you have a working Internet connection before downloading the app.



Plug In a USB Flash Drive and Turn On the DIR-506L

Insert your USB drive into the USB port on the DIR-506L. Slide the power switch to the ON position and wait until the power, USB, and wireless LEDs turn green. Please allow 3-4 minutes for the boot-up process to complete.

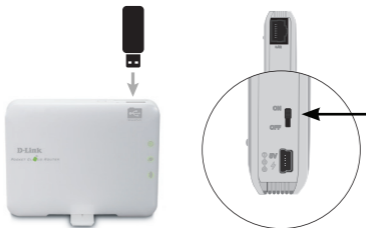

Connect to the DIR-506L Wirelessly

Use the following information to connect to your DIR-506L wirelessly:

- Default WiFi SSID: **dlink_DIR-506L**
- Default Password: *(leave this blank)*



Using The SharePort Mobile App

1. Open the SharePort Mobile app.



2. Make sure the Wireless icon at the bottom of the screen is blue, then you're ready to use SharePort Mobile!



If you set the device password for the DIR-506L, or if you want to use a specific user account, tap on the gear icon in the top right corner of the screen to open the settings page, then tap **Edit** to enter your User Name and Password. By default, the User Name is **admin**, and the Password should be left blank. When you're finished, tap **Done**.

Using a PC with SharePort Mobile

You can use a PC to access files on a USB drive plugged into the DIR-506L by opening a web browser and going to **http://dlinkrouter.local:8181**

WEB FILE ACCESS LOGIN

Log in to the web file access Server :

User Name :
Password :

By default, the User Name is **admin**, and the Password should be left blank. When you're finished, tap **Done**.

If you want to use a specific user account, enter your User Name and Password for that account.

Getting Connected to the Internet

Wireless Router Mode

Share a wired Internet connection

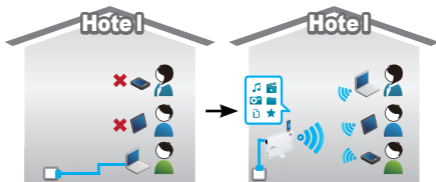

Whether you're at home or at a hotel, the Pocket Cloud Router makes it easy to share your Internet connection with all your devices. Just plug your modem or Internet connection cable into the Ethernet port on the Pocket Cloud Router to share your connection wirelessly.

WiFi Hotspot Mode

Share a hotspot connection with friends

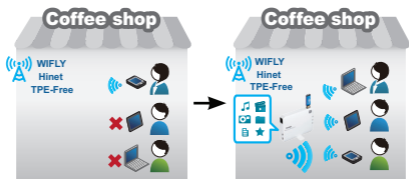

At a café or at the airport, you can share access to a wireless hotspot with all your friends and devices with the Pocket Cloud Router's WiFi Hotspot Mode. The Pocket Cloud Router connects to the hotspot, then shares access through a private wireless network you control.

Connection Setup with QRS Mobile

If you wish to use Wireless Router Mode, you can configure your DIR-506L with the handy QRS Mobile app for iOS and Android mobile devices.

Use a barcode scanner app such as **Bakodo** or **RedLaser** on your iOS or Android device to scan the corresponding code for your device below. If you do not have a scanning app, just search for **QRS Mobile** in the App Store or Google Play. Please make sure you have a working Internet connection before downloading the app.



After downloading the app, connect to the DIR-506L wirelessly using the following information:

- Default WiFi SSID: **dlink_DIR-506L**
- Default Password: *(leave this blank)*

You can now open the QRS Mobile app and follow the on-screen instructions to configure your DIR-506L.

Connection Setup Through a Browser

You can use a web browser on your PC or mobile device to configure your DIR-506L for Wireless Router and WiFi Hotspot mode, as well as all of the other modes and settings.

1. Connect to the DIR-506L wirelessly using the following information:
 - Default WiFi SSID: **dlink_DIR-506L**
 - Default Password: *(leave this blank)*
2. Open a web browser, and go to **http://dlinkrouter.local**. By default, the User Name is **admin**, and the Password should be left blank.

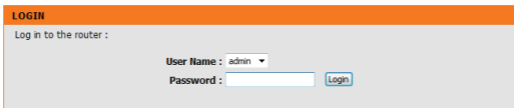

LOGIN

Log in to the router :

User Name : admin ▾

Password :

3. After logging in, click on **Setup** at the top, then click on **Internet Connection Setup Wizard** and follow the on-screen instructions.

Further Information

For further information on how to use, configure, and enjoy your DIR-506L, you can refer to the User Manual, which is available on the D-Link website.

For the D-Link website for your region, refer to the following Technical Support pages.

Technical Support

Australia:

Tel: 1300-766-868
 24/7 Technical Support
 Web: <http://www.dlink.com.au>
 E-mail: support@dlink.com.au

India:

Tel: +91-22-27626600
 Toll Free: 1800-22-8998
 Web: www.dlink.co.in
 E-Mail: helpdesk@dlink.co.in

Singapore, Thailand, Indonesia, Malaysia, Philippines, Vietnam:

Singapore: www.dlink.com.sg
 Thailand: www.dlink.co.th
 Indonesia: www.dlink.co.id
 Malaysia: www.dlink.com.my
 Philippines: www.dlink.com.ph
 Vietnam: www.dlink.com.vn

Korea:

Tel: +82-2-2028-1810
 Monday to Friday 9:00am to 6:00pm
 Web: <http://d-link.co.kr>
 E-mail: g2b@d-link.co.kr

New Zealand:

Tel: 0800-900-900
 24/7 Technical Support
 Web: <http://www.dlink.co.nz>
 E-mail: support@dlink.co.nz

South Africa and Sub Sahara Region:

Tel: +27 12 661 2025
 08600 DLINK (for South Africa only)
 Monday to Friday
 8:30am to 9:00pm South Africa Time
 Web: <http://www.d-link.co.za>
 E-mail: support@d-link.co.za

Saudi Arabia (KSA):

Tel: +966 01 217 0008
 Fax: +966 01 217 0009
 Saturday to Wednesday 9.30AM to 6.30PM
 Thursdays 9.30AM to 2.00 PM
 E-mail: Support.sa@dlink-me.com

D-Link Middle East - Dubai, U.A.E.

Plot No. S31102,
 Jebel Ali Free Zone South,
 P.O.Box 18224, Dubai, U.A.E.
 Tel: +971-4-8809022
 Fax: +971-4-8809066 / 8809069
 Technical Support: +971-4-8809033
 General Inquiries: info.me@dlink-me.com
 Tech Support: support.me@dlink-me.com

Egypt

1, Makram Ebeid Street - City Lights Building
 Nasrcity - Cairo, Egypt
 Floor 6, office C2
 Tel: +2 02 26718375 - +2 02 26717280
 Technical Support: +2 02 26738470
 General Inquiries: info.eg@dlink-me.com
 Tech Support: support.eg@dlink-me.com

Kingdom of Saudi Arabia

Office # 84,
 Al Khaleej Building (Mujamathu Al-Khaleej)
 Opp. King Fahd Road, Olaya
 Riyadh - Saudi Arabia
 Tel: +966 1 217 0008
 Technical Support:
 +966 1 2170009 / +966 2 6522951
 General Inquiries: info.sa@dlink-me.com
 Tech Support: support.sa@dlink-me.com

Technical Support

Pakistan

Islamabad Office:

61-A, Jinnah Avenue, Blue Area,
Suite # 11, EBC, Saudi Pak Tower,
Islamabad - Pakistan
Tel: +92-51-2800397, 2800398
Fax: +92-51-2800399

Karachi Office:

D-147/1, KDA Scheme # 1,
Opposite Mudassar Park, Karsaz Road,
Karachi - Pakistan
Tel: +92-21-34548158, 34326649
Fax: +92-21-4375727
Technical Support: +92-21-34548310, 34305069
General Inquiries: info.pk@dlink-me.com
Tech Support: support.pk@dlink-me.com

Iran

Unit 5, 5th Floor, No. 20, 17th Alley, Bokharest St.,
Argentine Sq.,
Tehran IRAN
Postal Code : 1513833817
Tel: +98-21-88880918,19
+98-21-88706653,54
General Inquiries: info.ir@dlink-me.com
Tech Support: support.ir@dlink-me.com

Morocco

M.I.T.C
Route de Nouaceur angle RS et CT 1029 Bureau
N° 312 ET 337
Casablanca, Maroc
Tel: +212 663 72 73 24
Email: support.na@dlink-me.com

Lebanon RMA center

Dbayah/Lebanon
PO Box:901589
Tel: +961 4 54 49 71 Ext:14
Fax: +961 4 54 49 71 Ext:12
Email: taoun@dlink-me.com

Bahrain

Technical Support: +973 1 3332904

Kuwait:

Technical Support: +965 22453939
+965 22453949

Türkiye Merkez İrtibat Ofisi

Ayazağa Maslak yolu
Erdebil Cevahir İş Merkezi No: 5/A Ayazağa /
Maslak İstanbul
Tel: +90 212 2895659
Ücretsiz Müşteri Destek Hattı: 0 800 211 00 65
Web:www.dlink.com.tr
Teknik Destek: support.tr@dlink.com.tr

Israel

מטלון סנטר
רח' המגשימים 20
קרית מטלון, פ"ת 49348
ת.ד. 7060
טלפון: 073-796-2797
אי-מאייל כללי: nfo@dlink.co.il
אי-מאייל תמיכה: support@dlink.co.il

Комплект поставки



Портативный маршрутизатор Cloud



USB-кабель (только для питания и зарядки аккумулятора)



Перезаряжаемый аккумулятор

Установка и зарядка аккумулятора

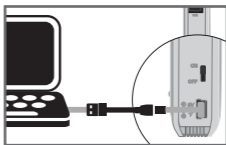
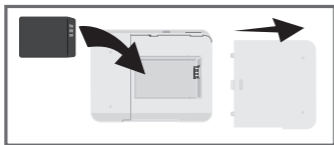

1. Для работы устройства необходимо установить аккумулятор. Сдвиньте крышку и установите аккумулятор. Убедитесь, что контакты аккумулятора совпадают с контактами отсека. Закройте крышку
2. Подключите USB-кабель к маршрутизатору DIR-506L и к USB-порту компьютера.

Примечание: Перед первым использованием необходимо заряжать аккумулятор с помощью USB-кабеля не менее 4 часов.

SharePort Mobile – Простой общий доступ к файлам

Передача видео, музыки, фотографий и документов выполняется с USB-носителя, подключенного к DIR-506L, непосредственно на Ваш iPhone, iPad, устройство Android или на компьютер; нет необходимости подключения к сети Интернет! Использование приложения SharePort Mobile позволяет преобразовать любой USB-накопитель в Ваше персональное хранилище данных с общим доступом.

Поддерживаемые форматы файлов для iOS и Android:

- Видео: .mp4, .mov
- Музыка: .mp3, .wav
- Изображения: .bmp, .gif, .jpg, .png
- Документация: .doc, .xls, .ppt, .pdf, .pages, .numbers, .key, .txt, .html, .ref

Загрузка приложения SharePort Mobile

Используйте на своем устройстве iOS или Android сканер штрих-кодов, например, Bakodo или RedLaser, чтобы сканировать соответствующий код. Если у Вас нет приложения для сканирования, просто воспользуйтесь поиском SharePort Mobile в App Store или Google Play. Перед загрузкой приложения, пожалуйста, убедитесь, что Интернет-соединение активно.



Подключение USB флэш-накопителя и включение маршрутизатора DIR-506L

Подключите USB-накопитель к USB-порту маршрутизатора DIR-506L. Установите переключатель в положение ON (ВКЛ) и подождите пока индикаторы Power, USB и Wireless загорятся зеленым светом. Пожалуйста, подождите 3-4 минуты, пока не завершится процесс перезагрузки.

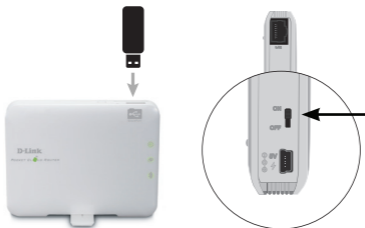

Подключение к маршрутизатору DIR-506L по Wi-Fi

Для подключения к DIR-506L по Wi-Fi используйте следующую информацию:

- WiFi SSID по умолчанию: **dlink_DIR-506L**
- *Пароль по умолчанию: (оставьте это поле пустым)*



Использование приложения SharePort

1. Откройте приложение SharePort Mobile.
2. Убедитесь, что значок беспроводного соединения внизу экрана синего цвета, это означает, что приложение SharePort Mobile готово к использованию.



При указании пароля для DIR-506L или необходимости использовать определенную учетную запись пользователя нажмите на значок в верхнем правом углу экрана, чтобы открыть страницу с настройками, затем нажмите **Edit (Редактировать)**, чтобы ввести Имя пользователя и Пароль. По умолчанию Имя пользователя – **admin**, поле с Паролем оставьте пустым. По завершении нажмите **Done (Готово)**.

Использование компьютера с SharePort Mobile

Для доступа к файлам на USB-носителе, подключенном к DIR 506L, откройте web-браузер и введите **http://dlinkrouter.local:8181**

WEB FILE ACCESS LOGIN

Log in to the web file access Server :

User Name :
Password :

По умолчанию Имя пользователя – **admin**, поле с Паролем оставьте пустым. По завершении нажмите **Done (Готово)**.

Если необходимо использовать определенную учетную запись введите Имя пользователя и Пароль данной учетной записи

Подключение к сети Интернет

Режим Wireless Router



Портативный маршрутизатор Cloud обеспечивает всем Вашим устройствам общий доступ к сети Интернет дома или в гостинице. Просто подключите модем или Интернет-кабель к Ethernet-порту портативного маршрутизатора Cloud, чтобы организовать общий доступ по беспроводной сети.

Режим WiFi Hotspot

Совместное использование Hotspot

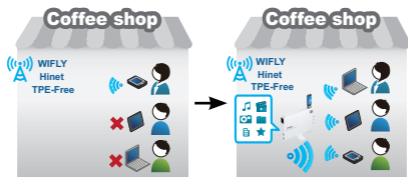

Благодаря режиму WiFi Hotspot Вы можете получить общий доступ в Интернет, находясь в зоне Hotspot в кафе или в аэропорту. Портативный маршрутизатор Cloud подключается к зоне беспроводного доступа к Интернет, затем предоставляет доступ к сетевым сервисам через подключение к управляемой Вами беспроводной сети.

Установка соединения с приложением QRS Mobile

Если необходимо использовать режим Wireless Router можно настроить маршрутизатор DIR 506L с удобным приложением QRS Mobile для мобильных устройств iOS и Android.

Используйте на своем устройстве iOS или Android сканер штрих-кодов, например, Bakodo или RedLaser, чтобы сканировать соответствующий штрих-код. Если у Вас нет приложения для сканирования, просто воспользуйтесь поиском SharePort Mobile в App Store или Google Play. Перед загрузкой приложения, пожалуйста, убедитесь, что Интернет-соединение активно.



После загрузки приложения подключитесь к DIR-506L по Wi-Fi, используя следующую информацию:

- WiFi SSID по умолчанию: **dlink_DIR-506L**
- Пароль по умолчанию: *(оставьте это поле пустым)*

Теперь можно открыть приложение QRS Mobile и выполнить инструкции по настройке DIR-506L, отображенные на экране.

Установка соединения через браузер

Для настройки режимов Wireless Router и Wi-Fi Hotspot, а также других режимов и настроек можно использовать web-браузер на компьютере или мобильном устройстве.

1. Подключите DIR-506L по Wi-Fi, используя следующую информацию:
 - WiFi SSID по умолчанию: **dlink_DIR-506L**
 - Пароль по умолчанию: *(оставьте это поле пустым)*
2. Откройте web-браузер и введите в адресной строке **http://dlinkrouter.local**. По умолчанию Имя пользователя – **admin**, поле с Паролем оставьте пустым.

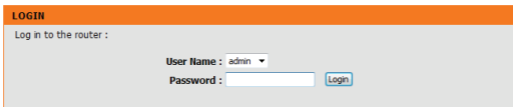

LOGIN

Log in to the router :

User Name : admin ▾

Password :

3. После авторизации нажмите **Setup (Установка)** в верхней части страницы, затем нажмите **Internet Connection Setup Wizard (Мастер установки Интернет-соединения)** и выполните инструкции на экране.

Дополнительная информация

Для получения дополнительной информации об использовании, настройке и преимуществах маршрутизатора DIR 506L обратитесь к Руководству пользователя, доступном на web-сайте поддержки D-Link.

Техническая поддержка

Обновления программного обеспечения и документация доступны на Интернет-сайте D-Link. D-Link предоставляет бесплатную поддержку для клиентов в течение гарантийного срока. Клиенты могут обратиться в группу технической поддержки D-Link по телефону или через Интернет.

Техническая поддержка D-Link:

+7(495) 744-00-99

Техническая поддержка через Интернет

<http://www.dlink.ru>

e-mail: support@dlink.ru

ОФИСЫ

Украина

04080 г. Киев, ул. Межигорская, 87-А, офис 18

Тел.: +38 (044) 545-64-40

E-mail: kiev@dlink.ru

Беларусь

220114, г. Минск, проспект Независимости, 169, БЦ "XXI Век"

Тел.: +375(17) 218-13-65

E-mail: minsk@dlink.ru

Казахстан

050008, г. Алматы, ул. Курмангазы, дом 143

(уг. Муканова)

Тел./факс: +7 727 378-55-90

E-mail: almaty@dlink.ru

Узбекистан

100015, г.Ташкент, ул. Нукусская, 89

Тел./Факс: +998 (71) 120-3770, 150-2646

E-mail: tashkent@dlink.ru

Армения

0038, г. Ереван, ул. Абяляна, 6/1, 4 этаж

Тел./Факс: + 374 (10) 398-667

E-mail: erevan@dlink.ru

Грузия

0162, г. Тбилиси, проспект Чавчавадзе 74, 10 этаж

Тел./Факс: + 995 (32) 244-563

Lietuva

09120, Vilnius, Žirmūnų 139-303

Tel./faks. +370 (5) 236-3629

E-mail: info@dlink.lt

Eesti

Peterburi tee 46-205

11415, Tallinn, Eesti, Susi Bürookeskus

tel +372 613 9771

e-mail: info@dlink.ee

Latvija

Mazā nometņu 45/53 (ieeja no Nāras ielas)

LV-1002, Rīga

tel.: +371 6 7618703 +371 6 7618703

e-pasts: info@dlink.lv

Contenido del Empaque



Cloud Router Pocket



Cable USB (Sólo para energizar y cargar batería)



Batería recargable

Insertar y cargar la batería

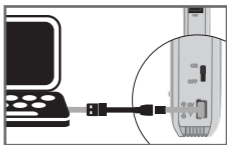
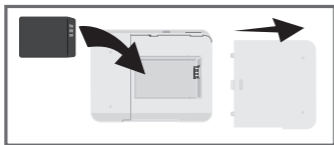

1. La batería debe estar instalada para que el dispositivo funcione. Deslice la tapa e inserte la batería. Asegúrese de que los contactos dorados estén alineados con los terminales dorados. Deslice la tapa.
2. Conecte el cable USB al DIR-506L y luego conéctelo a un puerto USB de su computador.

Nota: Cargue el dispositivo con el cable USB durante al menos 4 horas o hasta que esté completamente cargada antes de su uso.

SharePort Mobile – Compartir se hizo fácil

Transmita películas, música, fotos y documentos desde una unidad USB conectada directamente del DIR-506L a su iPhone, iPad o dispositivo Android, o en un PC, usted ni siquiera necesita estar conectado a Internet! SharePort Mobile transforma cualquier unidad USB en su propio espacio personal de archivos compartidos que se pueden acceder con todos sus dispositivos.

Formatos de archivos compatibles para iOS y Android:

- Video: .mp4, .mov.
- Música: .mp3, .wav.
- Imagen: .bmp, .gif, .jpg, .png
- Documento: .Doc, .xls, .ppt, .pdf, .pages, .numbers, .key, .txt, .html, .ref

Descargar la aplicación Shareport Mobile

Utilizar una aplicación de escáner de códigos de barras como Bakodo o RedLaser en su iOS o Android para escanear el código correspondiente a su dispositivo. Si no dispone de una aplicación de análisis, buscar SharePort Mobile en la App Store o Google Play. Por favor, asegúrese de tener una conexión a Internet antes de descargar la aplicación.



Conecte una unidad flash USB y encienda el DIR-506L

Inserte la unidad USB en el puerto USB del router DIR-506L. Deslice el interruptor de encendido en la posición ON y espere hasta que el LED power, USB inalámbrico se encuentre verde. Por favor permita 3-4 minutos para que el proceso de arranque se complete.



Conectarse al DIR-506L inalámbricamente

Utilice la siguiente información para conectarse a su DIR-506L inalámbricamente:

- WiFi SSID Predeterminado: **dlink_DIR-506L**
- Contraseña por defecto: *(dejar en blanco)*



Utilizar la aplicación SharePort Mobile

1. Abra la aplicación SharePort Mobile.



2. Asegúrese de que el icono inalámbrico en la parte inferior de la pantalla es azul, entonces usted está listo para usar SharePort móvil!



Si establece la contraseña del dispositivo para el DIR-506L, o si desea utilizar una cuenta de usuario específica, pulse en el icono de engranaje en la esquina superior derecha de la pantalla para abrir la página de configuración, a continuación, pulse **Editar (Edit)** para introducir su nombre de usuario y contraseña. Por defecto, el nombre de usuario es **admin** y la contraseña debe dejarse en blanco. Cuando termine, toque **Hecho (Done)**.

Utilizar un PC con SharePort Mobile

Puede utilizar un PC para acceder a los archivos en un disco USB conectado al DIR-506L, abra un explorador Web y vaya a **http://dlinkrouter.local:8181**

WEB FILE ACCESS LOGIN

Log in to the web file access Server :

User Name :

Password :

Por defecto, el nombre de usuario es **admin** y la contraseña debe dejarse en blanco. Cuando haya terminado, toque **Hecho (Done)**.

Si desea utilizar una cuenta de usuario específica, escriba su nombre de usuario y contraseña para esa cuenta.

Cómo realizar la conexión a Internet

Modo Router Wireless

Compartir una conexión a Internet por cable

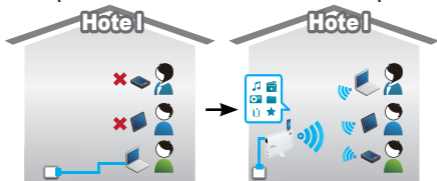

Ya sea que esté en casa o en un hotel, el Cloud Router Pocket hace que sea fácil de compartir su conexión a Internet con todos sus dispositivos. Sólo tiene que conectar el módem de cable o conexión a Internet en el puerto Ethernet Cloud Router Pocket para compartir su conexión inalámbrica.

ESPAÑOL

Modo WiFi Hotspot

Compartir una conexión de punto de acceso con los amigos

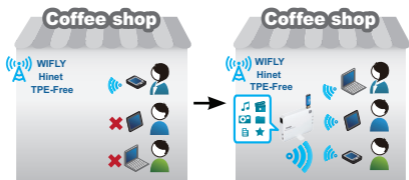

En una cafetería o en el aeropuerto, se puede compartir el acceso a un hotspot inalámbrico con todos sus amigos y dispositivos con el Modo Hotspot WiFi del Cloud Router Pocket. El Cloud Router Pocket conecta al Hotspot, y luego comparte el acceso a través de una red inalámbrica privada que usted controla.

Configuración de conexión con QRS Mobile

Si desea utilizar el modo de router inalámbrico, puede configurar sus DIR-506L con la aplicación práctica del QRS Mobile para dispositivos iOS y Android móviles.

Utilice una aplicación de escáner de código de barras como Bakodo o RedLaser en su dispositivo iOS o Android para escanear el código correspondiente a su dispositivo a continuación. Si usted no tiene una aplicación de análisis, buscar QRS Mobile en la App Store o Google Play. Por favor, asegúrese de tener una conexión a Internet antes de descargar la aplicación.



Utilice la siguiente información para conectarse a su DIR-506L inalámbricamente:

- WiFi SSID Predeterminado: **dlink_DIR-506L**
- Contraseña por defecto: *(dejar en blanco)*

Ahora puede abrir la aplicación móvil QRS y siga las instrucciones que aparecen en pantalla para configurar el router DIR-506L.

Configuración de la conexión a través de un navegador

Se puede utilizar un navegador web en su PC o dispositivo móvil para configurar el router DIR-506L para router inalámbrico y el modo WiFi Hotspot, así como todos los otros modos y ajustes.

1. Utilice la siguiente información para conectarse a su DIR-506L inalámbricamente:
 - WiFi SSID Predeterminado: **dlink_DIR-506L**
 - Contraseña por defecto: *(dejar en blanco)*
2. Abra un navegador web y vaya a **http://dlinkrouter.local**. Por defecto, el nombre de usuario es **admin** y la contraseña debe dejarse en blanco.

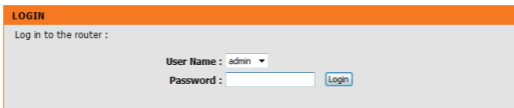

LOGIN

Log in to the router :

User Name : admin ▾

Password :

3. Después de iniciar sesión, haga clic en Configuración (**Setup**) en la parte superior, a continuación, haga clic en Asistente de configuración de conexión a Internet (**Internet Connection Setup Wizard**) y siga las instrucciones que aparecen en pantalla.

Más información

Para más información sobre cómo utilizar, configurar y disfrutar de su DIR-506L, puede consultar el manual del usuario, el cual está disponible en el sitio web de D-Link.

Para el sitio web de D-Link de su región, consulte las páginas de asistencia técnica siguientes.

Soporte Técnico

Usted puede encontrar actualizaciones de softwares o firmwares y documentación para usuarios a través de nuestro sitio www.dlinkla.com

SOPORTE TÉCNICO PARA USUARIOS EN LATINO AMERICA

Soporte técnico a través de los siguientes teléfonos de D-Link

| PAIS | NUMERO |
|-------------|------------------|
| Argentina | 0800 - 12235465 |
| Chile | 800 260200 |
| Colombia | 01800 - 510070 |
| Costa Rica | 0800 - 0521478 |
| Ecuador | 1800 - 035465 |
| El Salvador | 800 - 6335 |
| Guatemala | 1800 - 8350255 |
| México | 01800 - 0626270 |
| Panamá | 011 008000525465 |
| Perú | 0800 - 00968 |
| Venezuela | 0800 - 1005767 |

Soporte Técnico de D-Link a través de Internet

Horario de atención Soporte Técnico en www.dlinkla.com
e-mail: soporte@dlinkla.com & consultas@dlinkla.com

Conteúdo da Embalagem



D-Link Cloud Pocket Router



Cabo USB (apenas para ligar e carregar a bateria)



Bateria Recarregável

Inserir e carregar a bateria

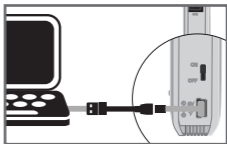
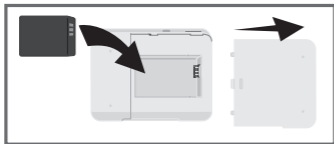

1. A bateria deve ser instalada primeiro, para que o dispositivo funcione. Retire a tampa e insira a bateria. Verifique se os contatos de ouro estão alinhados com os terminais de ouro. Deslize a tampa.
2. Conecte o cabo USB ao DIR-506L e depois conecte ele a uma porta USB do seu computador.

Nota: Carregue o dispositivo usando o cabo USB antes de usar, por pelo menos 4 horas ou até que a bateria esteja totalmente carregada.

SharePort Mobile – Compartilhamento simplificado

Acesse de seu iPhone, iPad, dispositivo Android, ou de um PC, filmes, músicas, fotos ou documentos, simplesmente conectando um pen drive USB ou HD externo na porta USB do DIR-506L, você não precisa nem estar conectado à Internet! O SharePort Mobile transforma qualquer pen drive ou HD externo USB em seu espaço de arquivo pessoal, compartilhando os arquivos para você acessar com todos os seus dispositivos.

Formatos de arquivo suportados para iOS e Android:

- Vídeo: .Mp4, mov.
- Música: .MP3, WAV.
- Imagem: .Bmp, .gif, .jpg, .png
- Documento: .Doc, .xls, .ppt, .pdf, .páginas, .números-chave, .txt, .html, .ref

Baixe a App do SharePort Mobile App

Use um aplicativo para ler o código de barras abaixo, como o Bakodo ou RedLaser em seu dispositivo com iOS ou Android. Caso você não tenha um aplicativo de análise e busca do SharePort Mobile na App Store ou no Google Play. Por favor, verifique se você tem uma conexão de Internet antes de baixar o App.



Conecte uma unidade USB como um pen drive e ligue o DIR-506L

Conecte o seu drive USB na porta USB do DIR-506L. Deslize o interruptor para a posição ON e espere até que o led de energia, USB wireless fiquem verde. Por favor, aguarde de 3 ou 4 minutos para o processo de inicialização para ser concluído.

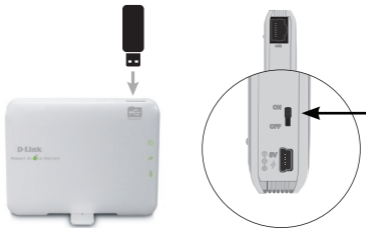

Como se conectar ao DIR-506L usando a rede sem fio

Use as seguintes informações para se conectar ao seu DIR-506L:

- Padrão do nome da rede sem fio (WiFi SSID): **dlink_DIR-506L**
- Senha padrão: *(deixe em branco)*



Usando o App SharePort Mobile

1. Abra o App SharePort Mobile.



2. Verifique se o ícone da rede sem fio na parte inferior da tela está azul, caso estiver você está pronto para usar SharePort Mobile!



Se você definir uma senha para o dispositivo DIR-506L, ou se você quiser usar uma conta de usuário específica, toque no ícone da engrenagem, no canto superior direito da tela para abrir a página de configurações, em seguida, toque em **Edit** para inserir o seu Nome de Usuário e senha. Por padrão, o nome de usuário é admin, e a senha deve ser deixado em branco. Quando terminar, toque em **Done**.

Usando um PC com o SharePort Mobile

Você pode usar um PC para acessar os arquivos em um drive USB conectado ao DIR-506L, basta abrir um navegador e digitar no campo de endereço **http://dlinkrouter.local:8181**

WEB FILE ACCESS LOGIN

Log in to the web file access Server :

User Name :
Password :

Por padrão, o nome de usuário é **admin**, e a senha deve ser deixado em branco. Quando terminar, toque em **Done**.

Se você quiser usar uma conta de usuário específica, digite seu nome de usuário e senha para essa conta.

Conectando-se à Internet

Modo Roteador sem fio (Wireless Router)

Compartilhar uma conexão de Internet com fio

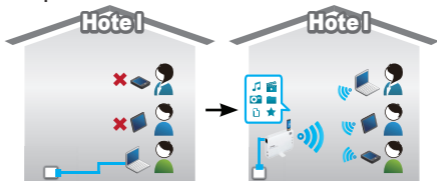

Se você está em casa ou em um hotel, o seu roteador irá torna mais fácil a tarefa de compartilhar sua conexão à Internet com todos os seus dispositivos. Basta ligar o seu modem ou cabo de conexão com a Internet na porta Ethernet do roteador para compartilhar sua conexão através de uma rede sem fio.

Modo WiFi Hotspot

Criar um hotspot para compartilhar uma conexão de Internet com os amigos

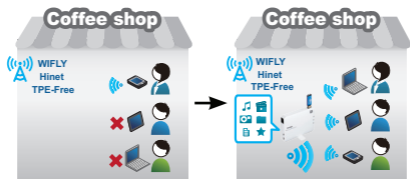

Em um café ou no aeroporto, você pode compartilhar o acesso a Internet com todos os seus amigos, permitindo o acesso dos dispositivos no modo Hotspot. O Roteador se conecta ao ponto de acesso, e então compartilha o acesso através de uma rede privada sem fio que você irá controlar.

Configuração através do App QRS Mobile

Se você deseja usar o modo Roteador Wireless, você pode configurar seu DIR-506L utilizando o App QRS Mobile para sistemas iOS e Android.

Use um leitor de código de barras, como o Bakodo ou o RedLaser em seu dispositivo iOS ou Android para ler o código abaixo, correspondente ao seu dispositivo. Se você não tiver um aplicativo de análise, busque o QRS Mobile na App Store ou no Google Play. Por favor, verifique se você tem uma conexão de Internet antes de baixar o app.



Depois de baixar o aplicativo, conecte-se a rede sem fio do DIR-506L com as seguintes informações:

- Nome padrão da rede sem fio (WiFi SSID): **dlink_DIR-506L**
- Senha padrão: *(deixe em branco)*

Agora você pode abrir o QRS Mobile app e seguir as instruções na tela para configurar o DIR-506L.

Configuração de conexão através de um navegador

Você pode usar um navegador da Web em seu PC ou dispositivo móvel para configurar o DIR-506L como Roteador Wireless ou como WiFi Hotspot, assim como todos os outros modos e configurações.

1. Conecte-se a rede sem fio do DIR-506L com as seguintes informações:
 - Nome da rede sem fio (WiFi SSID): **dlink_DIR-506L**
 - Senha padrão: *(deixe em branco)*
2. Abra um navegador e digite na barra de endereço **http://dlinkrouter.local**. Por padrão, o nome de usuário é **admin**, e a senha deve ser deixado em branco.

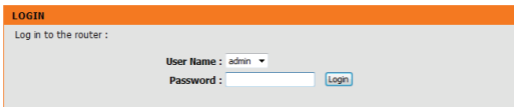

3. Após o login, clique em **Setup** no topo, em seguida, clique em on **Internet Connection Setup** e siga as instruções na tela

Mais Informações

Para mais informações sobre como utilizar, configurar e desfrutar do seu DIR-506L, você pode consultar o Manual do Usuário, que está disponível no site da D-Link.

Para acessar o site da D-Link em sua região, consulte as seguintes páginas de Suporte Técnico.

Suporte Técnico

Caso tenha dúvidas na instalação do produto, entre em contato com o Suporte Técnico D-Link.

Acesse o site: www.dlink.com.br/suporte

Isi Kemasan



Pocket Cloud Router



Kabel USB (hanya untuk daya dan pengisian baterai)



Baterai Isi Ulang

Memasang dan Mengisi Baterai

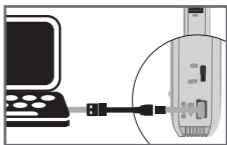
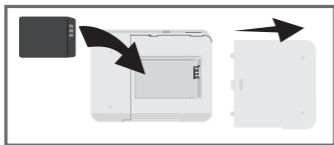

1. Baterai harus terpasang supaya perangkat dapat digunakan. Geser penutup dan masukkan baterai. Pastikan kontak yang berwarna emas sudah sejajar dengan kontak berwarna emas dari perangkat. Geser dan kembalikan penutup ke posisi semula.
2. Sambungkan kabel USB pada DIR-506L dan hubungkan ke port USB pada komputer anda.

Catatan: Isi baterai dengan kabel USB untuk sekitar 4 jam atau sampai baterai terisi penuh sebelum penggunaan.

SharePort Mobile – Berbagi menjadi mudah

Berbagi film, musik, foto dan dokumen dari USB flash disk yang tercolok ke DIR-506L melalui iPhone, iPad, perangkat Android atau PC; anda bahkan tidak perlu terhubung ke internet! SharePort Mobile membuat USB anda menjadi tempat berbagi data yang dapat diakses oleh perangkat anda yang lainnya.

Format file yang didukung untuk iOS dan Android:

- Video: .mp4, .mov
- Musik: .mp3, .wav
- Gambar: .bmp, .gif, .jpg, .png
- Dokumen: .doc, .xls, .ppt, .pages, .numbers, .key, .txt, .html, .ref

Mengunduh SharePort Mobile App

Gunakan program pemindai barcode seperti Bakodo atau RedLaser dari iOS atau Android anda untuk melakukan scan kode untuk perangkat anda. Bila anda tidak memiliki program pemindai, anda cukup mencari aplikasi SharePort Mobile di App Store atau Google Play. Pastikan perangkat anda terhubung dengan internet sebelum mengunduh.



Colokkan USB flash disk dan hidupkan DIR-506L

Masukkan USB flash disk ke port USB dari DIR-506L. Geser saklar daya ke posisi ON dan tunggu hingga lampu LED daya, USB dan Wireless menjadi hijau. Tunggu 3-4 menit hingga perangkat menyelesaikan proses boot awal.

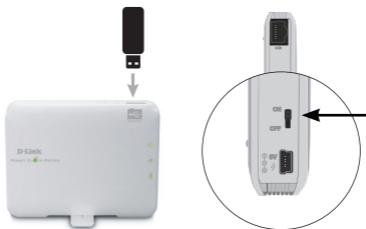

Terhubung ke DIR-506L secara Nirkabel

Gunakan informasi dibawah ini untuk terhubung ke DIR-506L secara nirkabel:

- SSID WiFi bawaan: **dlink_DIR-506L**
- Kata sandi bawaan: *(biarkan kosong)*



Menggunakan aplikasi SharePort Mobile

1. Aktifkan aplikasi SharePort Mobile.
2. Pastikan ikon Wireless pada bagian bawah layar berwarna biru, kemudian anda bisa menggunakan SharePort Mobile!



Apabila anda telah mengatur kata sandi DIR-506L atau apabila anda ingin menggunakan akun pengguna khusus, tekan ikon "Gear" pada bagian kanan atas dari layar untuk membuka halaman pengaturan, kemudian tekan pada "**Edit**" kemudian masukkan Nama Pengguna dan Kata Sandi. Secara bawaan, nama pengguna adalah **admin** dan kata sandi dibiarkan kosong. Bila anda selesai, tekan **Done**.

Menggunakan SharePort Mobile pada PC

Anda dapat menggunakan PC untuk mengakses data pada USB yang terhubung ke DIR-506L dengan membuka web browser dengan alamat **http://dlinkrouter.local:8181**

WEB FILE ACCESS LOGIN

Log in to the web file access Server :

User Name :
Password :

Secara bawaan, Nama pengguna adalah **admin** dan biarkan kata sandi kosong. Bila anda selesai, tekan **Done**.

Bila anda menggunakan nama pengguna yang khusus, masukkan nama pengguna dan kata sandi untuk akun anda.

Terhubung ke Internet

Modus Router Nirkabel

Berbagi jaringan kabel

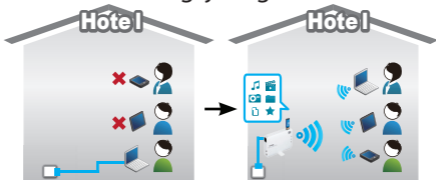

Apakah anda di rumah maupun di hotel, Pocket Cloud Router memudahkan anda untuk berbagi jaringan Internet ke semua perangkat lainnya. Cukup colokkan jaringan dari modem ke port Ethernet dari Pocket Cloud router untuk berbagi koneksi anda secara nirkabel.

Modus WiFi Hotspot

Berbagi koneksi hotspot dengan teman

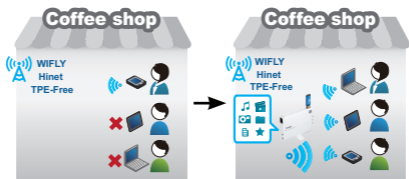

Saat di kafe atau di bandara, anda dapat berbagi koneksi jaringan melalui hotspot ke teman anda maupun perangkat lainnya melalui modus WiFi Hotspot dari Pocket Cloud Router. Perangkat Pocket Cloud Router terhubung ke hotspot kemudian membagikan akses tersebut melalui jaringan privat dalam kendali anda.

Pengaturan Koneksi dengan QRS Mobile

Bila anda ingin menggunakan modus Router Nirkabel, anda dapat mengatur DIR-506L dengan aplikasi QRS Mobile untuk iOS dan Android.

Gunakan aplikasi pemindai barcode seperti Bakudo atau RedLaser pada perangkat iOS atau Android anda. Bila anda tidak memiliki aplikasi pemindai, cari aplikasi QRS Mobile di App Store atau Google Play. Pastikan anda terhubung ke Internet sebelum mengunduh aplikasi.



Setelah mengunduh aplikasi, hubungkan ke DIR-506L secara nirkabel dengan menggunakan informasi berikut:

- SSID WiFi bawaan: **dlink_DIR-506L**
- Kata sandi bawaan : (*biarkan kosong*)

Anda dapat membuka aplikasi QRS Mobile dan ikuti instruksi untuk mengatur DIR-506L anda.

Pengaturan Koneksi melalui Web Browser

Anda dapat menggunakan web browser pada PC atau perangkat mobile anda untuk mengatur DIR-506L untuk modus Router Nirkabel, WiFi Hotspot serta pengaturan modus lainnya.

1. Hubungkan ke DIR-506L secara nirkabel dengan informasi berikut:
 - SSID WiFi bawaan: **dlink_DIR-506L**
 - Kata sandi bawaan : *(biarkan kosong)*
2. Buka web browser dan masukkan alamat **http://dlinkrouter.local**. Secara umum, nama pengguna adalah **admin** dan biarkan kata sandi kosong

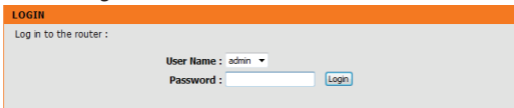

3. Setelah login, klik pada **Setup** di bagian atas, kemudian klik **Internet Connection Setup Wizard** dan ikuti instruksi pada layar.

Informasi lebih lanjut

Untuk informasi lebih lanjut tentang cara pengoperasian, pengaturan serta penggunaan DIR-506L, anda dapat mengakses Manual Penggunaan yang tersedia di situs D-Link.

Untuk situs D-Link sesuai daerah anda, silahkan lihat pada halaman Technical Support.

Dukungan Teknis

Update perangkat lunak dan dokumentasi pengguna dapat diperoleh pada situs web D-Link.
Dukungan Teknis untuk pelanggan:

Dukungan Teknis D-Link melalui telepon:

Tel: +62-21-5731610

Dukungan Teknis D-Link melalui Internet:

Email : support@dlink.co.id

Website : <http://support.dlink.co.id>

D-Link GPL Code Statement:

This D-Link product includes software code developed by third parties, including software code subject to the GNU General Public License ("GPL") or GNU Lesser General Public License ("LGPL"). As applicable, the terms of the GPL and LGPL, and information on obtaining access to the GPL Code and LGPL Code used in this product, are available to you at:

<http://tsd.dlink.com.tw/GPL.asp>

The GPL Code and LGPL Code used in this product is distributed WITHOUT ANY WARRANTY and is subject to the copyrights of one or more authors. For details, see the GPL Code and the LGPL Code for this product and the terms of the GPL and LGPL.

Written Offer for GPL Source Code:

Whereas such specific license terms entitle you to the source code of such software, D-Link will provide upon written request via email and/or traditional paper mail the applicable GPL source code files via CD-ROM for a nominal cost to cover shipping and media charges as allowed under the GPL and LGPL. Please direct all inquiries to:

Email:

GPLCODE@DLink.com

Snail Mail:

Attn: GPLSOURCE REQUEST
D-Link Systems, Inc.
17595 Mt. Herrmann Street
Fountain Valley, CA 92708

GNU GENERAL PUBLIC LICENSE

Version 2, June 1991

Copyright (C) 1989, 1991 Free Software Foundation, Inc.
51 Franklin Street, Fifth Floor, Boston, MA 02110-1301, USA

Everyone is permitted to copy and distribute verbatim copies of this license document, but changing it is not allowed.

Preamble

The licenses for most software are designed to take away your freedom to share and change it. By contrast, the GNU General Public License is intended to guarantee your freedom to share and change free software—to make sure the software is free for all its users. This General Public License applies to most of the Free Software Foundation's software and to any other program whose authors commit to using it. (Some other Free Software Foundation software is covered by the GNU Library General Public License instead.) You can apply it to your programs, too.

When we speak of free software, we are referring to freedom, not price. Our General Public Licenses are designed to make sure that you have the freedom to distribute copies of free software (and charge for this service if you wish), that you receive source code or can get it if you want it, that you can change the software or use pieces of it in new free programs; and that you know you can do these things.

To protect your rights, we need to make restrictions that forbid anyone to deny you these rights or to ask you to surrender the rights. These restrictions translate to certain responsibilities for you if you distribute copies of the software, or if you modify it. For example, if you distribute copies of such a program, whether gratis or for a fee, you must give the recipients all the rights that you have. You must make sure that they, too, receive or can get the source code. And you must show them these terms so they know their rights.

We protect your rights with two steps: (1) copyright the software, and (2) offer you this license which gives you legal permission to copy, distribute and/or modify the software.

Also, for each author's protection and ours, we want to make certain that everyone understands that there is no warranty for this free software. If the software is modified by someone else and passed on, we want its recipients to know that what they have is not the original, so that any problems introduced by others will not reflect on the original authors' reputations.

Finally, any free program is threatened constantly by software patents. We wish to avoid the danger that redistributors of a free program will individually obtain patent licenses, in effect making the program proprietary. To prevent this, we have made it clear that any patent must be licensed for everyone's free use or not licensed at all.

The precise terms and conditions for copying, distribution and modification follow.

GNU GENERAL PUBLIC LICENSE TERMS AND CONDITIONS FOR COPYING, DISTRIBUTION AND MODIFICATION

0. This License applies to any program or other work which contains a notice placed by the copyright holder saying it may be distributed under the terms of this General Public License. The “Program”, below, refers to any such program or work, and a “work based on the Program” means either the Program or any derivative work under copyright law: that is to say, a work containing the Program or a portion of it, either verbatim or with modifications and/or translated into another language. (Hereinafter, translation is included without limitation in the term “modification”.) Each licensee is addressed as “you”.

Activities other than copying, distribution and modification are not covered by this License; they are outside its scope. The act of running the Program is not restricted, and the output from the Program is covered only if its contents constitute a work based on the Program (independent of having been made by running the Program). Whether that is true depends on what the Program does.

1. You may copy and distribute verbatim copies of the Program’s source code as you receive it, in any medium, provided that you conspicuously and appropriately publish on each copy an appropriate copyright notice and disclaimer of warranty; keep intact all the notices that refer to this License and to the absence of any warranty; and give any other recipients of the Program a copy of this License along with the Program.

You may charge a fee for the physical act of transferring a copy, and you may at your option offer warranty protection in exchange for a fee.

2. You may modify your copy or copies of the Program or any portion of it, thus forming a work based on the Program, and copy and distribute such modifications or work under the terms of Section 1 above, provided that you also meet all of these conditions:

- a) You must cause the modified files to carry prominent notices stating that you changed the files and the date of any change.
- b) You must cause any work that you distribute or publish, that in whole or in part contains or is derived from the Program or any part thereof, to be licensed as a whole at no charge to all third parties under the terms of this License.
- c) If the modified program normally reads commands interactively when run, you must cause it, when started running for such interactive use in the most ordinary way, to print or display an announcement including an appropriate copyright notice and a notice that there is no warranty (or else, saying that you provide a warranty) and that users may redistribute the program under these conditions, and telling the user how to view a copy of this License. (Exception: if the Program itself is interactive but does not normally print such an announcement, your work based on the Program is not required to print an announcement.)

These requirements apply to the modified work as a whole. If identifiable sections of that work are not derived from the Program, and can be reasonably considered independent and separate works in themselves, then this License, and its terms, do not apply to those sections when you distribute them as separate works. But when you distribute the same sections as part of a whole which is a work based on the Program, the distribution of the whole must be on the terms of this License, whose permissions for other licensees extend to the entire whole, and thus to each and every part regardless of who wrote it.

Thus, it is not the intent of this section to claim rights or contest your rights to work written entirely by you; rather, the intent is to exercise the right to control the distribution of derivative or collective works based on the Program.

In addition, mere aggregation of another work not based on the Program with the Program (or with a work based on the Program) on a volume of a storage or distribution medium does not bring the other work under the scope of this License.

3. You may copy and distribute the Program (or a work based on it, under Section 2) in object code or executable form under the terms of Sections 1 and 2 above provided that you also do one of the following:

- a) Accompany it with the complete corresponding machine-readable source code, which must be distributed under the terms of Sections 1 and 2 above on a medium customarily used for software interchange; or,
- b) Accompany it with a written offer, valid for at least three years, to give any third party, for a charge no more than your cost of physically performing source distribution, a complete machine-readable copy of the corresponding source code, to be distributed under the terms of Sections 1 and 2 above on a medium customarily used for software interchange; or,
- c) Accompany it with the information you received as to the offer to distribute corresponding source code. (This alternative is allowed only for noncommercial distribution and only if you received the program in object code or executable form with such an offer, in accord with Subsection b above.)

The source code for a work means the preferred form of the work for making modifications to it. For an executable work, complete source code means all the source code for all modules it contains, plus any associated interface definition files, plus the scripts used to control compilation and installation of the executable. However, as a special exception, the source code distributed need not include anything that is normally distributed (in either source or binary form) with the major components (compiler, kernel, and so on) of the operating system on which the executable runs, unless that component itself accompanies the executable.

If distribution of executable or object code is made by offering access to copy from a designated place, then offering equivalent access to copy the source code from the same place counts as distribution of the source code, even though third parties are not compelled to copy the source along with the object code.

4. You may not copy, modify, sublicense, or distribute the Program except as expressly provided under this License. Any attempt otherwise to copy, modify, sublicense or distribute the Program is void, and will automatically terminate your rights under this License. However, parties who have received copies, or rights, from you under this License will not have their licenses terminated so long as such parties remain in full compliance.

5. You are not required to accept this License, since you have not signed it. However, nothing else grants you permission to modify or distribute the Program or its derivative works. These actions are prohibited by law if you do not accept this License. Therefore, by modifying or distributing the Program (or any work based on the Program), you indicate your acceptance of this License to do so, and all its terms and conditions for copying, distributing or modifying the Program or works based on it.

6. Each time you redistribute the Program (or any work based on the Program), the recipient automatically receives a license from the original licensor to copy, distribute or modify the Program subject to these terms and conditions. You may not impose any further restrictions on the recipients' exercise of the rights granted herein. You are not responsible for enforcing compliance by third parties to this License.

7. If, as a consequence of a court judgment or allegation of patent infringement or for any other reason (not limited to patent issues), conditions are imposed on you (whether by court order, agreement or otherwise) that contradict the conditions of this License, they do not excuse you from the conditions of this License. If you cannot distribute so as to satisfy simultaneously your obligations under this License and any other pertinent obligations, then as a consequence you may not distribute the Program at all. For example, if a patent license would not permit royalty-free redistribution of the Program by all those who receive copies directly or indirectly through you, then the only way you could satisfy both it and this License would be to refrain entirely from distribution of the Program.

If any portion of this section is held invalid or unenforceable under any particular circumstance, the balance of the section is intended to apply and the section as a whole is intended to apply in other circumstances.

It is not the purpose of this section to induce you to infringe any patents or other property right claims or to contest validity of any such claims; this section has the sole purpose of protecting the integrity of the free software distribution system, which is implemented by public license practices. Many people have made generous contributions to the wide range of software distributed through that system in reliance on consistent application of that system; it is up to the author/donor to decide if he or she is willing to distribute software through any other system and a licensee cannot impose that choice.

This section is intended to make thoroughly clear what is believed to be a consequence of the rest of this License.

8. If the distribution and/or use of the Program is restricted in certain countries either by patents or by copyrighted interfaces, the original copyright holder who places the Program under this License may add an explicit geographical distribution limitation excluding those countries, so that distribution is permitted only in or among countries not thus excluded. In such case, this License incorporates the limitation as if written in the body of this License.

9. The Free Software Foundation may publish revised and/or new versions of the General Public License from time to time. Such new versions will be similar in spirit to the present version, but may differ in detail to address new problems or concerns.

Each version is given a distinguishing version number. If the Program specifies a version number of this License which applies to it and “any later version”, you have the option of following the terms and conditions either of that version or of any later version published by the Free Software Foundation. If the Program does not specify a version number of this License, you may choose any version ever published by the Free Software Foundation.

10. If you wish to incorporate parts of the Program into other free programs whose distribution conditions are different, write to the author to ask for permission. For software which is copyrighted by the Free Software Foundation, write to the Free Software Foundation; we sometimes make exceptions for this. Our decision will be guided by the two goals of preserving the free status of all derivatives of our free software and of promoting the sharing and reuse of software generally.

NO WARRANTY

11. BECAUSE THE PROGRAM IS LICENSED FREE OF CHARGE, THERE IS NO WARRANTY FOR THE PROGRAM, TO THE EXTENT PERMITTED BY APPLICABLE LAW. EXCEPT WHEN OTHERWISE STATED IN WRITING THE COPYRIGHT HOLDERS AND/OR OTHER PARTIES PROVIDE THE PROGRAM “AS IS” WITHOUT WARRANTY OF ANY KIND, EITHER EXPRESSED OR IMPLIED, INCLUDING, BUT NOT LIMITED TO, THE IMPLIED WARRANTIES OF MERCHANTABILITY AND FITNESS FOR A PARTICULAR PURPOSE. THE ENTIRE RISK AS TO THE QUALITY AND PERFORMANCE OF THE PROGRAM IS WITH YOU. SHOULD THE PROGRAM PROVE DEFECTIVE, YOU ASSUME THE COST OF ALL NECESSARY SERVICING, REPAIR OR CORRECTION.

12. IN NO EVENT UNLESS REQUIRED BY APPLICABLE LAW OR AGREED TO IN WRITING WILL ANY COPYRIGHT HOLDER, OR ANY OTHER PARTY WHO MAY MODIFY AND/OR REDISTRIBUTE THE PROGRAM AS PERMITTED ABOVE, BE LIABLE TO YOU FOR DAMAGES, INCLUDING ANY GENERAL, SPECIAL, INCIDENTAL OR CONSEQUENTIAL DAMAGES ARISING OUT OF THE USE OR INABILITY TO USE THE PROGRAM (INCLUDING BUT NOT LIMITED TO LOSS OF DATA OR DATA BEING RENDERED INACCURATE OR LOSSES SUSTAINED BY YOU OR THIRD PARTIES OR A FAILURE OF THE PROGRAM TO OPERATE WITH ANY OTHER PROGRAMS), EVEN IF SUCH HOLDER OR OTHER PARTY HAS BEEN ADVISED OF THE POSSIBILITY OF SUCH DAMAGES.

END OF TERMS AND CONDITIONS

How to Apply These Terms to Your New Programs

If you develop a new program, and you want it to be of the greatest possible use to the public, the best way to achieve this is to make it free software which everyone can redistribute and change under these terms.

To do so, attach the following notices to the program. It is safest to attach them to the start of each source file to most effectively convey the exclusion of warranty; and each file should have at least the "copyright" line and a pointer to where the full notice is found.

```
<one line to give the program's name and a brief idea of what it does.>  
Copyright (C) <year> <name of author>
```

This program is free software; you can redistribute it and/or modify it under the terms of the GNU General Public License as published by the Free Software Foundation; either version 2 of the License, or (at your option) any later version.

This program is distributed in the hope that it will be useful, but WITHOUT ANY WARRANTY; without even the implied warranty of MERCHANTABILITY or FITNESS FOR A PARTICULAR PURPOSE. See the GNU General Public License for more details.

You should have received a copy of the GNU General Public License along with this program; if not, write to the Free Software Foundation, Inc., 51 Franklin Street, Fifth Floor, Boston, MA 02110-1301, USA

Also add information on how to contact you by electronic and paper mail.

If the program is interactive, make it output a short notice like this when it starts in an interactive mode:

```
Gnomovision version 69, Copyright (C) year name of author  
Gnomovision comes with ABSOLUTELY NO WARRANTY; for details type `show w'.
```

```
This is free software, and you are welcome to redistribute it under certain conditions; type  
`show c' for details.
```

The hypothetical commands `show w' and `show c' should show the appropriate parts of the General Public License. Of course, the commands you use may be called something other than `show w' and `show c'; they could even be mouse-clicks or menu items-- whatever suits your program.

You should also get your employer (if you work as a programmer) or your school, if any, to sign a “copyright disclaimer” for the program, if necessary. Here is a sample; alter the names:

Yoyodyne, Inc., hereby disclaims all copyright interest in the program ‘Gnomovision’ (which makes passes at compilers) written by James Hacker.

<signature of Ty Coon>, 1 April 1989
Ty Coon, President of Vice

This General Public License does not permit incorporating your program into proprietary programs. If your program is a subroutine library, you may consider it more useful to permit linking proprietary applications with the library. If this is what you want to do, use the GNU Library General Public License instead of this License.

NOTES

NOTES

NOTES

NOTES

NOTES

WIRELESS NETWORK REMINDER

Wireless Network Name (SSID)

Wireless Network Password