

D-Link®

WIRELESS N 300 CLOUD ROUTER
DIR-605L

**QUICK
INSTALLATION
GUIDE**

РУКОВОДСТВО ПО БЫСТРОЙ УСТАНОВКЕ

GUÍA DE INSTALACIÓN RÁPIDA

GUIA DE INSTALAÇÃO RÁPIDA

快速安裝指南

PETUNJUK PEMASANGAN CEPAT

CONTENTS OF PACKAGING

CONTENTS



WIRELESS N 300 CLOUD ROUTER
DIR-605L



POWER ADAPTER
ADAPTER



ETHERNET CABLE
CONNECT THE ROUTER TO YOUR PC DURING SET-UP



If any of these items are missing from your packaging contact your reseller

PRODUCT SETUP

INSTALL YOUR ROUTER

Step 1

Position your router close to your modem and the computer that is already online. Place this router in an open area of your intended work area for better wireless coverage.

Step 2

Unplug the Ethernet cable from your modem that is connected to your computer. Plug it into the LAN port labeled 1 on the back of your router. The router is now connected to your computer.

Step 3

Find another Ethernet cable and plug the of end of this cable into the port labeled INTERNET on the back of the router. Plug the other end of this cable into the Ethernet port on your modem.

Step 4

Connect the supplied power adapter into the power port on the back of the router and then plug into a power outlet or surge protector. Verify the power light is lit. Below is a basic network setup.

PRODUCT SETUP

RUN EASY SETUP WIZARD AND mydlink SERVICE

Step 1

From the computer you connected to the router, open a web browser and you will be directed to the D-Link Setup Wizard page, which detects INTERNET connection type.

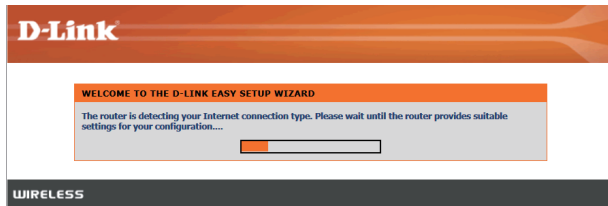
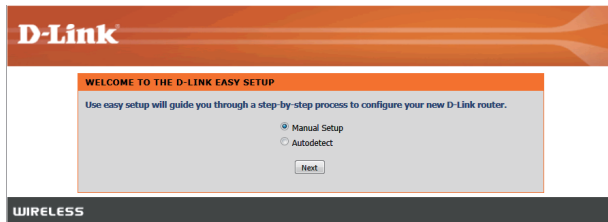
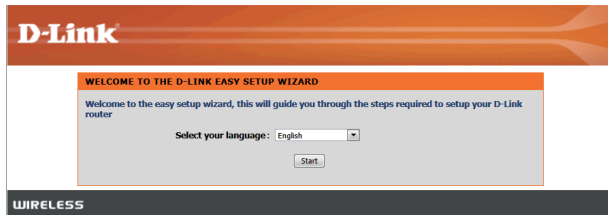

PRODUCT SETUP

ENGLISH

RUN EASY SETUP WIZARD AND mydlink SERVICE

Step 2

According to the detection result, follow the on-screen instructions to configure your INTERNET setting.

D-Link

STEP 1: CONFIGURE YOUR INTERNET CONNECTION

Internet Connection

The result of Wan auto detection is: Dynamic IP (DHCP)

Internet Connection: Dynamic IP (DHCP) [What is this?](#)

Wireless Settings

Network Name (SSID): dink

Security Mode: Disable Wireless Security (Not recommended)
 AUTO-WPA/WPA2(Recommended)

Network Key: Auto generate network key

WIRELESS

STEP 1: CONFIGURE YOUR INTERNET CONNECTION

Internet Connection

The result of Wan auto detection is: Dynamic IP (DHCP)

Internet Connection: PPPoE [What is this?](#)

User Name: (is required field)

*Password:

*Confirm Password:

Wireless Settings

Network Name (SSID): dink

Security Mode: Disable Wireless Security (Not recommended)
 AUTO-WPA/WPA2(Recommended)

Network Key: Auto generate network key

STEP 1: CONFIGURE YOUR INTERNET CONNECTION

Internet Connection

The result of Wan auto detection is: Dynamic IP (DHCP)

Internet Connection: Static IP [What is this?](#)

IP Address: 0.0.0.0 (is required field)

*Subnet Mask: 255.255.255.0

*Gateway Address: 0.0.0.0

*Primary DNS Server: 0.0.0.0

Secondary DNS Server: 0.0.0.0

Wireless Settings

Network Name (SSID): dink

Security Mode: Disable Wireless Security (Not recommended)
 AUTO-WPA/WPA2(Recommended)

Network Key: Auto generate network key

PRODUCT SETUP

RUN EASY SETUP WIZARD AND mydlink SERVICE

Step 3

In the page of "CURRENT NETWORK SETTING", you will see the INTERNET status is "connected".

EASY SETUP COMPLETE

After clicking the "Save" button, you need to provide your username and password to access the device when logging in next time.

Internet Settings

Internet Connection : Dynamic IP (DHCP) Status : **Connected**

Wireless Settings

Wireless Network Name (SSID) : dlink Status : **Unsecured** [Configure](#)

Security : Disabled

Your current wireless security settings are not safe. We recommend you configure wireless settings.

Device Info

User Name : admin
Password :

mydlink Account

You have not activated mydlink service Status : **Not Connected** [Configure](#)

Save my network settings

[Save](#)

Step 4

If you have not registered a mydlink account, please click "configure" In the section "mydlink account" and complete the registration form.

Click "Register"

Do you have mydlink account ?

Yes, I have a mydlink account.

No, I want to register and login with a new mydlink account.

Please fulfill the options to complete the registration.

E-mail Address (Account Name) : [What is this?](#)

Password :

Confirm Password :

Last name :

First Name :

Device User Name :

Device Password :

I Accept the mydlink terms and conditions

[Register](#) [Back](#)

PRODUCT SETUP

ENGLISH

RUN EASY SETUP WIZARD AND mydlink SERVICE

Step 5

Now you can see the hint that a verification e-mail has been sent out. Open a new browser to login your e-mail account for receiving the verification mail.

Once the account verification phase is complete, click "next"

Step 6

Now the router has successfully connected to mydlink service. You can download the App "mydlink lite" from android market or apple store to start enjoy mydlink service!

CURRENT NETWORK SETTING

The current network settings and the connection status are displayed below. If you want to reconfigure your wireless settings, please click the "Configure" button. You can also enter advanced settings by clicking "Manual Setup".

Internet Settings	Internet Connection : Dynamic IP (DHCP)	Status : Connected
Wireless Settings	Network Name (SSID) : dlink	Status : Encryption Configure
	Security : Auto (WPA or WPA2) - Personal	
	Network Key : 12345678	
Device Info	User Name : admin	
	Password : admin	
mydlink Account	mydlink service is activated	Status : Connected Configure

Save my network settings

[Save](#)

mydlink™

E-mail

Password

Stay signed in

[Sign in](#)



TROUBLESHOOTING

SET-UP AND CONFIGURATION PROBLEMS

- 1. HOW DO I CONFIGURE MY DIR-605L ROUTER, OR CHECK MY WIRELESS NETWORK NAME (SSID) AND WIRELESS ENCRYPTION KEY?**
 - Connect your PC to the router using an Ethernet cable.
 - Open a web browser and enter the address `http://dlinkrouter` or `http://192.168.0.1`
 - The default username is 'admin'. The default password is "" (leave the field blank).
 - If you have changed the password and can not remember it, you will need to reset the router to set the password back to "" (leave the field blank).

- 2. HOW DO I RESET MY DIR-605L ROUTER TO FACTORY DEFAULT SETTINGS?**
 - Ensure the router is powered on.
 - Press and hold the reset button on the rear of the device for 20 seconds.
Note: Resetting the router to factory default will erase the current configuration settings. To re-configure your settings, log into the router as outlined in question 1, then run the Setup Wizard.

- 3. HOW DO I ADD A NEW WIRELESS CLIENT OR PC IF I HAVE FORGOTTEN MY WIRELESS NETWORK NAME (SSID) OR WIRELESS ENCRYPTION KEY?**
 - Every PC that needs to connect to the router wirelessly, you will need to ensure you use the correct Wireless Network Name (SSID) and encryption key.
 - Use the web based user interface (as described in question 1 above) to check or choose your wireless settings.
 - Make sure you write down these settings so that you can enter them into each wirelessly connected PC. You will find a dedicated area on the back of this document, this important information for future use.

- 4. WHY CAN I NOT GET AN INTERNET CONNECTION?**
 - For ADSL users please contact your ISP to make sure the service has been enabled/connected by your ISP and that your ISP username and password is correct.

TECHNICAL SUPPORT

You can find software updates and user documentation on the D-Link website.

Tech Support for customers in**Australia:**

Tel: 1300-766-868
24/7 Technical Support
Web: <http://www.dlink.com.au>
E-mail: support@dlink.com.au

India:

Tel: +91-22-27626600
Toll Free 1800-22-8998
Web: www.dlink.co.in
E-Mail: helpdesk@dlink.co.in

Singapore, Thailand, Indonesia, Malaysia, Philippines, Vietnam:

Singapore - www.dlink.com.sg
Thailand - www.dlink.co.th
Indonesia - www.dlink.co.id
Malaysia - www.dlink.com.my
Philippines - www.dlink.com.ph
Vietnam - www.dlink.com.vn

Korea:

Tel : +82-2-2028-1810
Monday to Friday 9:00am to 6:00pm
Web : <http://d-link.co.kr>
E-mail : g2b@d-link.co.kr

New Zealand:

Tel: 0800-900-900
24/7 Technical Support
Web: <http://www.dlink.co.nz>
E-mail: support@dlink.co.nz

South Africa and Sub Sahara Region:

Tel: +27 12 661 2025
08600 DLINK (for South Africa only)
Monday to Friday 8:30am to 9:00pm South Africa Time
Web: <http://www.d-link.co.za>
E-mail: support@d-link.co.za

Saudi Arabia (KSA):

Tel: +966 01 217 0008
Fax: +966 01 217 0009
Saturday to Wednesday 9.30AM to 6.30PM
Thursdays 9.30AM to 2.00 PM
E-mail: Support.sa@dlink-me.com

D-Link Middle East - Dubai, U.A.E.

Plot No. S31102,
Jebel Ali Free Zone South,
P.O.Box 18224, Dubai, U.A.E.
Tel: +971-4-8809022
Fax: +971-4-8809066 / 8809069
Technical Support: +971-4-8809033
General Inquiries: info.me@dlink-me.com
Tech Support: support.me@dlink-me.com

Egypt

1, Makram Ebeid Street - City Lights Building
Nasrcity - Cairo, Egypt
Floor 6, office C2
Tel.: +2 02 26718375 - +2 02 26717280
Technical Support: +2 02 26738470
General Inquiries: info.eg@dlink-me.com
Tech Support: support.eg@dlink-me.com

Kingdom of Saudi Arabia

Office # 84 ,
Al Khaleej Building (Mujamathu Al-Khaleej)
Opp. King Fahd Road, Olaya
Riyadh - Saudi Arabia
Tel: +966 1 217 0008
Technical Support:
+966 1 2170009 / +966 2 6522951
General Inquiries: info.sa@dlink-me.com
Tech Support: support.sa@dlink-me.com

Pakistan

Islamabad Office:
61-A, Jinnah Avenue, Blue Area,
Suite # 11, EBC, Saudi Pak Tower,
Islamabad - Pakistan
Tel.: +92-51-2800397, 2800398
Fax: +92-51-2800399

Karachi Office:

D-147/1, KDA Scheme # 1,
Opposite Mudassir Park, Karsaz Road,
Karachi – Pakistan
Phone: +92-21-34548158, 34326649
Fax: +92-21-4375727
Technical Support: +92-21-34548310, 34305069
General Inquiries: info.pk@dlink-me.com
Tech Support: support.pk@dlink-me.com

TECHNICAL SUPPORT

Iran

Unit 5, 5th Floor, No. 20, 17th Alley , Bokharest
St. , Argentine Sq. ,
Tehran IRAN
Postal Code : 1513833817
Tel: +98-21-88880918,19
+98-21-88706653,54
General Inquiries: info.ir@dlink-me.com
Tech Support: support.ir@dlink-me.com

Morocco

M.I.T.C
Route de Nouaceur angle RS et CT 1029
Bureau N° 312 ET 337
Casablanca , Maroc
Phone : +212 663 72 73 24
Email: support.na@dlink-me.com

Lebanon RMA center

Dbayeh/Lebanon
PO Box:901589
Tel: +961 4 54 49 71 Ext:14
Fax: +961 4 54 49 71 Ext:12
Email: taoun@dlink-me.com

Bahrain

Technical Support: +973 1 3332904

Kuwait:

Technical Support: + 965 22453939 / +965
22453949

Türkiye Merkez İrtibat Ofisi

Ayazağa Maslak yolu
Erdebil Cevahir İş Merkezi No: 5/A Ayazağa /
Maslak İstanbul
Tel: +90 212 2895659
Ücretsiz Müşteri Destek Hattı: 0 800 211 00 65
Web:www.dlink.com.tr
Teknik Destek: support.tr@dlink.com.tr

ISRAEL

מטלון סנטר
רח' המגשימים 20
קרית מטלון, פ"ת 49348
ת.ד. 7060
טלפון: 073-796-2797
אי-מאיל כללי: info@dlink.co.il
אי-מאיל תמיכה: support@dlink.co.il

Комплектация

Содержание

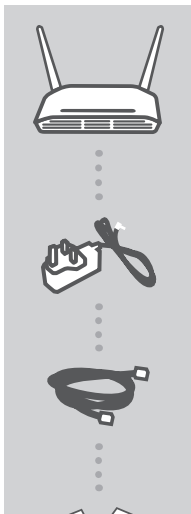

WIRELESS N 300 CLOUD ROUTER
DIR-605L

АДАПТЕР ПИТАНИЯ

КАБЕЛЬ ETHERNET
ДЛЯ ПОДКЛЮЧЕНИЯ УСТРОЙСТВА К СЕТИ



Если что-либо из перечисленного отсутствует, пожалуйста, обратитесь к поставщику

РУССКИЙ

Настройка устройства

Установка маршрутизатора

Шаг 1

Расположите маршрутизатор рядом с модемом и компьютером, которые уже подключены к сети. Располагайте маршрутизатор на открытом пространстве вашего рабочего места для лучшего покрытия сигнала.

Шаг 2

Отключите Ethernet кабель от модема, который подключен к компьютеру. Подключите его к LAN порту 1 на задней панели маршрутизатора. Теперь маршрутизатор подключен к компьютеру.

Шаг 3

Подключите конец Ethernet-кабеля к порту с пометкой INTERNET на задней панели маршрутизатора. Подключите другой конец кабеля к порту Ethernet на вашем модеме.

Шаг 4

Подключите прилагаемый адаптер питания к разъему питания на задней панели маршрутизатора, а затем - к розетке или сетевому фильтру. Убедитесь, что индикатор питания загорелся. Ниже приведены основные настройки сети.

Настройка устройства

Запуск SETUP WIZARD и сервиса mydlink

Шаг 1

Откройте Web-браузер на компьютере, подключенном к маршрутизатору, далее произойдет перенаправление на страницу Мастера установки D-Link, на которой указан тип ИНТЕРНЕТ-соединения.

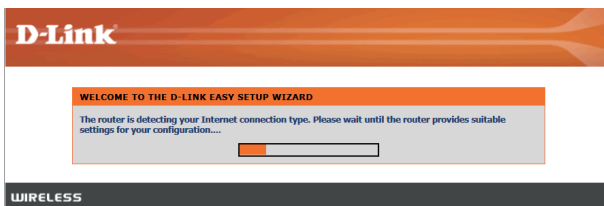
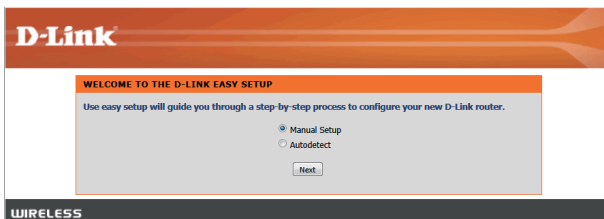
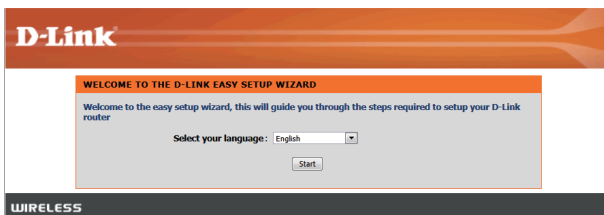

Настройка устройства

РУССКИЙ

Запуск SETUP WIZARD и сервиса mydlink

Шаг 2

Следуйте инструкциям на экране, чтобы настроить интернет-соединение.

D-Link

STEP 1: CONFIGURE YOUR INTERNET CONNECTION

Internet Connection

The result of Wan auto detection is: Dynamic IP (DHCP)

Internet Connection: Dynamic IP (DHCP) [What is this?](#)

Wireless Settings

Network Name (SSID): dlink

Security Mode: Disable Wireless Security (Not recommended)
 AUTO-WPA/WPA2(Recommended)

Network Key: Auto generate network key

[Prev](#) [Next](#)

WIRELESS

STEP 1: CONFIGURE YOUR INTERNET CONNECTION

Internet Connection

The result of Wan auto detection is: Dynamic IP (DHCP)

Internet Connection: PPPoE [What is this?](#)

User Name: (is required field)

*Password:

*Confirm Password:

Wireless Settings

Network Name (SSID): dlink

Security Mode: Disable Wireless Security (Not recommended)
 AUTO-WPA/WPA2(Recommended)

Network Key: Auto generate network key

[Prev](#) [Next](#)

STEP 1: CONFIGURE YOUR INTERNET CONNECTION

Internet Connection

The result of Wan auto detection is: Dynamic IP (DHCP)

Internet Connection: Static IP [What is this?](#)

IP Address: 0.0.0.0 (is required field)

*Subnet Mask: 255.255.255.0

*Gateway Address: 0.0.0.0

*Primary DNS Server: 0.0.0.0

Secondary DNS Server: 0.0.0.0

Wireless Settings

Network Name (SSID): dlink

Security Mode: Disable Wireless Security (Not recommended)
 AUTO-WPA/WPA2(Recommended)

Network Key: Auto generate network key

[Prev](#) [Next](#)

Настройка устройства

Запуск SETUP WIZARD и сервиса mydlink

РУССКИЙ

Шаг 3

На странице "CURRENT NETWORK SETTING", вы увидите статус Интернет-соединения: "подключено".

The screenshot shows the 'EASY SETUP COMPLETE' page with the following sections:

- Internet Settings:** Internet Connection: Dynamic IP (DHCP) Status: **Connected**
- Wireless Settings:** Wireless Network Name (SSID): dink Status: **Unsecured** (with a 'Configure' button). Security: Disabled. A note states: "Your current wireless security settings are not safe. We recommend you configure wireless settings."
- Device Info:** User Name: admin Password: (empty)
- mydlink Account:** You have not activated mydlink service Status: **Not Connected** (with a 'Configure' button).

At the bottom, there is a checkbox for "Save my network settings" and a "Save" button.

Шаг 4

Если вы еще не зарегистрированы в mydlink, пожалуйста, нажмите "Настроить" в разделе "mydlink account" и заполните форму регистрации.

Нажмите "Зарегистрироваться"

The screenshot shows the registration form with the following fields and options:

- Do you have mydlink account?
 - Yes, I have a mydlink account.
 - No, I want to register and login with a new mydlink account.
- Please fulfill the options to complete the registration.
- E-mail Address (Account Name): [text input] [What is this?](#)
- Password: [text input]
- Confirm Password: [text input]
- Last name: [text input]
- First Name: [text input]
- Device User Name: [text input] (pre-filled with 'admin')
- Device Password: [text input]
- [I Accept the mydlink terms and conditions](#)
- Buttons: Register, Back

Настройка устройства

РУССКИЙ

Запуск SETUP WIZARD и сервиса mydlink

Шаг 5

На вашу почту будет выслано письмо с подтверждением регистрации. Откройте новое окно в браузере, и войдите в ваш почтовый ящик для подтверждения регистрации. После подтверждения регистрации, нажмите "next"

Шаг 6

Теперь маршрутизатор успешно подключен к сервису mydlink. Вы можете скачать приложение "mydlink lite" из Android Market или Apple Store и наслаждаться mydlink службой!

CURRENT NETWORK SETTING

The current network settings and the connection status are displayed below. If you want to reconfigure your wireless settings, please click the "Configure" button. You can also enter advanced settings by clicking "Manual Setup".

Internet Settings

Internet Connection : Dynamic IP (DHCP) Status : **Connected**

Wireless Settings

Network Name (SSID) : dlink Status : **Encryption**
Configure

Security : Auto (WPA or WPA2) - Personal

Network Key : 12345678

Device Info

User Name : admin
Password : admin

mydlink Account

mydlink service is activated Status : **Connected**
Configure

Save my network settings

Save

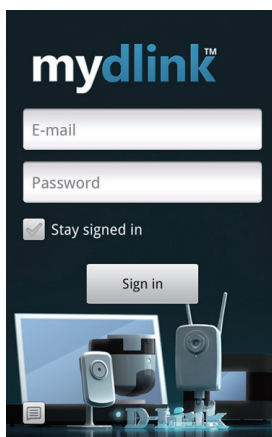

Устранение неисправности

Проблемы установки и настройки

1. Как я могу настроить DIR-605L маршрутизатор, проверить имя сети и ключ шифрования?

- Подключите компьютер к маршрутизатору с помощью Ethernet кабеля.
- Откройте веб-браузер и введите адрес <http://dlinkrouter> или <http://192.168.0.1>
- Имя пользователя по умолчанию 'admin'. Поле ввода пароля по умолчанию пустое.
- Если вы изменили пароль и не можете его вспомнить, вам необходимо сбросить настройки маршрутизатора, чтобы поле ввода пароля стало пустым.

2. Как мне сбросить DIR-605L маршрутизатор к заводским настройкам?

- Убедитесь, что маршрутизатор включен.
- Нажмите и удерживайте кнопку сброса на задней панели устройства в течение 20 секунд.

Замечание: Сброс маршрутизатора к заводским настройкам очистит настройки текущей конфигурации. Чтобы заново настроить параметры, войдите в маршрутизатор, как указано в вопросе 1, а затем запустите мастер установки (Setup Wizard).

3. Как я могу добавить нового пользователя или компьютер, если я забыл имя сети или ключ шифрования?

- Чтобы подключить компьютер к маршрутизатору нужно убедиться, что вы используете правильное имя сети и ключ шифрования.
- Используйте веб-интерфейс, как описано выше, чтобы проверить, или изменить ваши беспроводные настройки.
- Запишите настройки на обратной стороне этого документа.

4. Почему я не могу подключиться к интернету?

- Если вы ADSL-пользователь, пожалуйста, свяжитесь с вашим провайдером, чтобы убедиться, что услуга была включена / подключена и что имя пользователя и пароль правильные.

ТЕХНИЧЕСКАЯ ПОДДЕРЖКА

Обновления программного обеспечения и документация доступны на Интернет-сайте D-Link. D-Link предоставляет бесплатную поддержку для клиентов в течение гарантийного срока.

Клиенты могут обратиться в группу технической поддержки D-Link по телефону или через Интернет.

РУССКИЙ

Техническая поддержка D-Link:

+7(495) 744-00-99

Техническая поддержка через Интернет

<http://www.dlink.ru>

e-mail: support@dlink.ru

ОФИСЫ

Украина,

04080 г. Киев , ул. Межигорская, 87-А, офис 18

Тел.: +38 (044) 545-64-40

E-mail: kiev@dlink.ru

Беларусь

220114, г. Минск, проспект Независимости,

169 , БЦ "XXI Век"

Тел.: +375(17) 218-13-65

E-mail: minsk@dlink.ru

Казахстан,

050008, г. Алматы, ул. Курмангазы, дом 143

(уг. Муканова)

Тел./факс: +7 727 378-55-90

E-mail: almaty@dlink.ru

Узбекистан

100015, г.Ташкент, ул. Нукусская, 89

Тел./Факс: +998 (71) 120-3770, 150-2646

E-mail: tashkent@dlink.ru

Армения

0038, г. Ереван, ул. Абеяна, 6/1, 4 этаж

Тел./Факс: + 374 (10) 398-667

E-mail: erevan@dlink.ru

Грузия

0162, г. Тбилиси,

проспект Чавчавадзе 74, 10 этаж

Тел./Факс: + 995 (32) 244-563

Lietuva

09120, Vilnius, Žirmūnų 139-303

Tel./faks. +370 (5) 236-3629

E-mail: info@dlink.lt

Eesti

Peterburi tee 46-205

11415, Tallinn, Eesti , Susi Bürookeskus

tel +372 613 9771

e-mail: info@dlink.ee

Latvija

Mazā nometņu 45/53 (ieeja no Nāras ielas)

LV-1002, Rīga

tel.: +371 6 7618703 +371 6 7618703

e-pasts: info@dlink.lv

CONTENIDOS DEL PAQUETE

CONTENIDOS

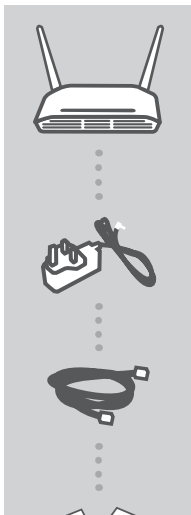

WIRELESS N 300 CLOUD ROUTER
DIR-605L

FUENTE DE ENERGÍA
ADAPTADOR

CABLE ETHERNET
CONECTE EL DISPOSITIVO A SU RED



Si alguno de los artículos no se encuentra, por favor contáctese con su vendedor

ESPAÑOL

INSTALACIÓN DE PRODUCTO

INSTALAR SU ROUTER

Paso 1

Instale su router cerca de su módem y al computador que ya está conectado. Coloque el router en un área abierta, en un área de trabajo destinado a la mejor cobertura inalámbrica.

Paso 2

Desconecte el cable Ethernet del módem que se conecta a su computador. Conéctelo al puerto LAN marcado 1 en la parte posterior de su router. El router estará conectado a su computador.

Paso 3

Busque otro cable Ethernet y conecte el extremo de este cable en el puerto con el nombre de INTERNET en la parte posterior del router. Conecte el otro extremo de este cable al puerto Ethernet de su módem.

Paso 4

Conecte la fuente de energía suministrado en el puerto de energía en la parte posterior del router y conéctelo a una toma de corriente o protector contra sobretensiones. Verifique que el indicador esté encendido. A continuación, se muestra una configuración de red básica.

INSTALACIÓN DE PRODUCTO

EJECUTAR ASISTENTE DE CONFIGURACIÓN Y SERVICIO mydlink

Paso 1

Desde el computador que está conectado al router, abra un navegador web y será dirigido a la página del Asistente de Configuración D-Link, que detecta el tipo de conexión a INTERNET.

ESPAÑOL

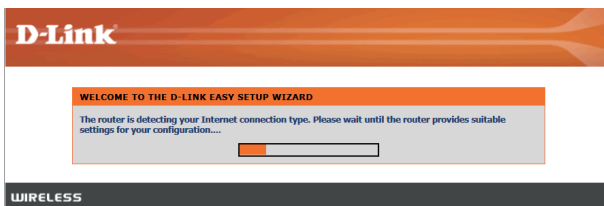
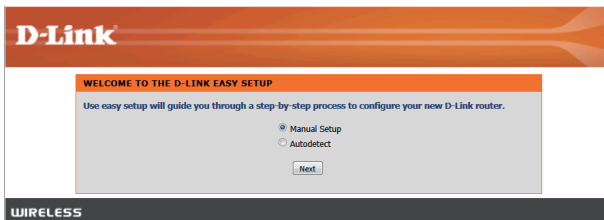
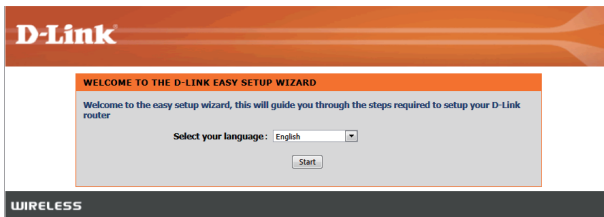

INSTALACIÓN DE PRODUCTO

EJECUTAR ASISTENTE DE CONFIGURACIÓN Y SERVICIO mydlink

Paso 2

De acuerdo con el resultado de la detección, siga las instrucciones de la pantalla para ajustar su configuración de INTERNET.

ESPAÑOL

D-Link

STEP 1: CONFIGURE YOUR INTERNET CONNECTION

Internet Connection
The result of Wan auto detection is: Dynamic IP (DHCP)
Internet Connection: Dynamic IP (DHCP) [What is this?](#)

Wireless Settings
Network Name (SSID) dlink
Security Mode Disable Wireless Security (Not recommended)
 ALTO-WPA/WPA2(Recommended)
Network Key
 Auto generate network key

[Prev](#) [Next](#)

WIRELESS

STEP 1: CONFIGURE YOUR INTERNET CONNECTION

Internet Connection
The result of Wan auto detection is: Dynamic IP (DHCP)
Internet Connection: PPPoE [What is this?](#)
User Name: (is required field)
*Password:
*Confirm Password:

Wireless Settings
Network Name (SSID) dlink
Security Mode Disable Wireless Security (Not recommended)
 ALTO-WPA/WPA2(Recommended)
Network Key
 Auto generate network key

[Prev](#) [Next](#)

STEP 1: CONFIGURE YOUR INTERNET CONNECTION

Internet Connection
The result of Wan auto detection is: Dynamic IP (DHCP)
Internet Connection: Static IP [What is this?](#)
IP Address: (is required field)
*Subnet Mask: 255.255.255.0
*Gateway Address:
*Primary DNS Server:
Secondary DNS Server:

Wireless Settings
Network Name (SSID) dlink
Security Mode Disable Wireless Security (Not recommended)
 ALTO-WPA/WPA2(Recommended)
Network Key
 Auto generate network key

[Prev](#) [Next](#)

INSTALACIÓN DE PRODUCTO

EJECUTAR ASISTENTE DE CONFIGURACIÓN Y SERVICIO mydlink

Paso 3

En la página de "CONFIGURACIÓN DE RED ACTUAL", verá que el estado de INTERNET es "conectado".

EASY SETUP COMPLETE

After clicking the "Save" button, you need to provide your username and password to access the device when logging in next time.

Internet Settings

Internet Connection : Dynamic IP (DHCP) Status : **Connected**

Wireless Settings

Wireless Network Name (SSID) : dlink Status : **Unsecured** [Configure](#)

Security : Disabled

Your current wireless security settings are not safe. We recommend you configure wireless settings.

Device Info

User Name : admin

Password :

mydlink Account

You have not activated mydlink service Status : **Not Connected** [Configure](#)

Save my network settings

[Save](#)

ESPAÑOL

Paso 4

Si no ha registrado una cuenta mydlink, por favor haga clic en "configurar" en la sección "cuenta mydlink" y complete el formulario de inscripción.

Haga clic en "Register"

Do you have mydlink account ?

Yes, I have a mydlink account.

No, I want to register and login with a new mydlink account.

Please fulfill the options to complete the registration.

E-mail Address (Account Name) : [What is this?](#)

Password :

Confirm Password :

Last name :

First Name :

Device User Name :

Device Password :

I Accept the mydlink terms and conditions

[Register](#) [Back](#)

INSTALACIÓN DE PRODUCTO

EJECUTAR ASISTENTE DE CONFIGURACIÓN Y SERVICIO mydlink

Paso 5

Ahora usted puede ver el mensaje que el e-mail de verificación ha sido enviado. Abra un nuevo navegador para acceder a su cuenta de correo electrónico para recibir el correo de verificación. Una vez que la fase de verificación de la cuenta se haya completado, haga clic en "next"

paso 6

Ahora el router se ha conectado correctamente al servicio mydlink. Puede descargar la aplicación "mydlink lite" de Android Market o Apple Store para comenzar a disfrutar del servicio mydlink!

ESPAÑOL

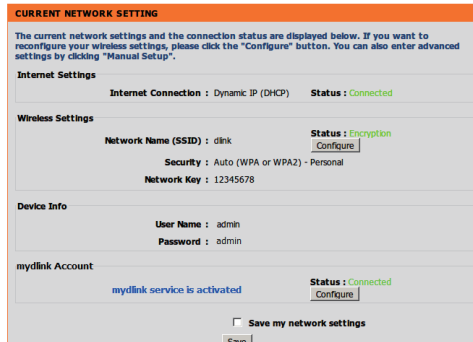

CURRENT NETWORK SETTING

The current network settings and the connection status are displayed below. If you want to reconfigure your wireless settings, please click the "Configure" button. You can also enter advanced settings by clicking "Manual Setup".

Internet Settings
Internet Connection : Dynamic IP (DHCP) Status : **Connected**

Wireless Settings
Network Name (SSID) : dlink Status : **Encryption** [Configure](#)
Security : Auto (WPA or WPA2) - Personal
Network Key : 12345678

Device Info
User Name : admin
Password : admin

mydlink Account
mydlink service is activated Status : **Connected** [Configure](#)

Save my network settings
[Save](#)

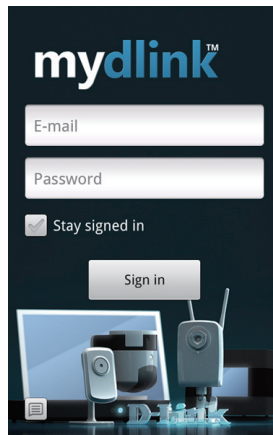

SOLUCIÓN DE PROBLEMAS

PROBLEMAS DE INSTALACIÓN Y CONFIGURACIÓN

1. ¿CÓMO CONFIGURO MI ROUTER DIR-605L, REVISAR MI NOMBRE DE RED INALÁMBRICA (SSID) Y LA CLAVE INALÁMBRICA?

- Conecte su PC al router mediante un cable Ethernet.
- Abra el navegador web e introduzca la dirección <http://dlinkrouter> o <http://192.168.0.1>.
- El nombre de usuario predeterminado es 'admin'. La contraseña por defecto debe quedar en blanco (dejar este cuadro vacío).
- Si ha cambiado la contraseña y no lo recuerda, tendrá que reiniciar el dispositivo para establecer la contraseña por defecto.

2. ¿CÓMO PUEDO RESTABLECER MI ROUTER DIR-605L A LOS VALORES POR DEFECTO DE FÁBRICA?

- Asegúrese de que el dispositivo está encendido.
- Mantenga presionado el botón de reset en la parte posterior del dispositivo durante 20 segundos.

Nota: Al restablecer la configuración del producto a fábrica, se borrará la configuración actual.

Para volver a ajustar la configuración, inicie sesión en el router como se indica en la pregunta 1, a continuación, ejecute el Asistente de Configuración.

3. ¿CÓMO PUEDO AÑADIR UN NUEVO CLIENTE INALÁMBRICO O PC SI HE OLVIDADO MI NOMBRE DE RED INALÁMBRICA (SSID) O CLAVE DE CIFRADO INALÁMBRICO?

- Para cada PC que necesite conectar con el Router de forma inalámbrica, tendrá que asegurarse de que utiliza el nombre correcto de la red inalámbrica (SSID) y la clave de cifrado.
- Utilice la interfaz de usuario basada en web (como se describe en la pregunta 1) para comprobar o elegir la configuración inalámbrica.
- Asegúrese de anotar estos valores para que pueda ingresarlos en cada PC que desee conectar inalámbricamente. Va a encontrar un espacio especial en la parte posterior de este documento para escribir esta información importante para el futuro.

4. ¿POR QUÉ NO PUEDO CONSEGUIR UNA CONEXIÓN A INTERNET?

- Para usuarios ADSL por favor contáctese con su ISP para asegurarse que el servicio está habilitado por su ISP y que su nombre de usuario ISP y contraseña son correctos.

SOPORTE TÉCNICO

Usted puede encontrar actualizaciones de softwares o firmwares y documentación para usuarios a través de nuestro sitio www.dlinkla.com

SOPORTE TÉCNICO PARA USUARIOS EN LATINO AMERICA

Soporte técnico a través de los siguientes teléfonos de D-Link

PAIS	NUMERO
Argentina	0800 - 12235465
Chile	800 260200
Colombia	01800 - 9525465
Costa Rica	0800 - 0521478
Ecuador	1800 - 035465
El Salvador	800 - 6335
Guatemala	1800 - 8350255
México	01800 - 1233201
Panamá	011 008000525465
Perú	0800 - 00968
Venezuela	0800 - 1005767

ESPAÑOL

Soporte Técnico de D-Link a través de Internet

Horario de atención Soporte Técnico en www.dlinkla.com

e-mail: soporte@dlinkla.com & consultas@dlinkla.com

CONTEÚDO DA EMBALAGEM

CONTEÚDO



WIRELESS N 300 CLOUD ROUTER
DIR-605L



FONTE DE ENERGIA
FONTE



CABO ETHERNET
CONECTA O DISPOSITIVO À SUA REDE

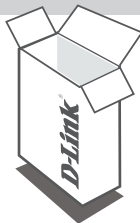

Se algum destes itens estiver faltando, entre em contato com o revendedor

PORTUGUÊS

CONFIGURAÇÃO DO PRODUTO

INSTALANDO SEU ROTEADOR

Passo 1

Posicione seu roteador próximo ao modem e o computador que já está online. Coloque este roteador em uma área aberta para melhor cobertura sem fio.

Passo 2

Desconecte o cabo Ethernet do seu modem, que está conectado ao seu computador. Conecte-o à porta LAN identificada com o número 1 na parte de trás do seu roteador. O roteador agora está conectado ao seu computador.

Passo 3

Conecte outro cabo Ethernet na porta rotulada INTERNET na parte de trás do roteador. Conecte a outra extremidade deste cabo à porta Ethernet no seu modem.

Passo 4

Conecte a fonte de energia fornecida à porta de energia na parte de trás do roteador e depois conecte a uma tomada ou filtro de linha. Verifique se a luz de energia está acesa. Abaixo está uma configuração básica de rede.

CONFIGURAÇÃO DO PRODUTO

ACESSE FACILMENTE O ASSISTENTE DE CONFIGURAÇÃO E O SERVIÇO mydlink

passo 1

A partir do computador que você conectado ao roteador, abra um navegador web. Você será direcionado para a página do Assistente de Configuração, que irá detectar o tipo de conexão da INTERNET.

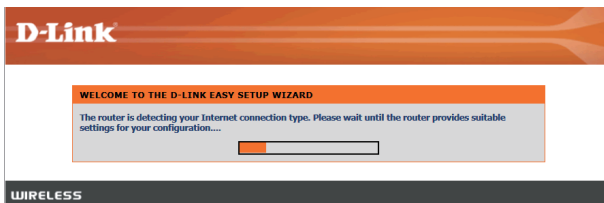
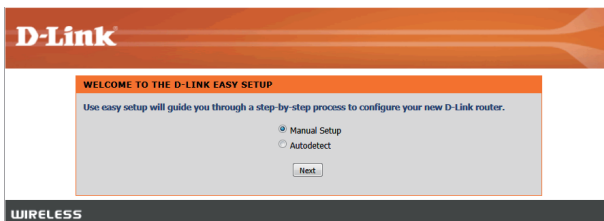
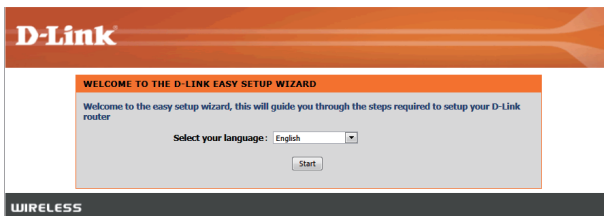

PORTUGUÊS

CONFIGURAÇÃO DO PRODUTO

ACESSE FACILMENTE O ASSISTENTE DE CONFIGURAÇÃO E O SERVIÇO mydlink

passo 2

De acordo com o resultado de detecção, siga as instruções na tela para configurar a INTERNET.

PORTUGUÊS

D-Link

STEP 1: CONFIGURE YOUR INTERNET CONNECTION

Internet Connection

The result of Wan auto detection is: Dynamic IP (DHCP)

Internet Connection: Dynamic IP (DHCP) [What is this?](#)

Wireless Settings

Network Name (SSID): dlink

Security Mode: Disable Wireless Security (Not recommended)
 AUTO-WPA/WPA2(Recommended)

Network Key:

Auto generate network key

[Prev](#) [Next](#)

WIRELESS

STEP 1: CONFIGURE YOUR INTERNET CONNECTION

Internet Connection

The result of Wan auto detection is: Dynamic IP (DHCP)

Internet Connection: PPPoE [What is this?](#)

*User Name:

*Password:

*Confirm Password:

Wireless Settings

Network Name (SSID): dlink

Security Mode: Disable Wireless Security (Not recommended)
 AUTO-WPA/WPA2(Recommended)

Network Key:

Auto generate network key

[Prev](#) [Next](#)

STEP 1: CONFIGURE YOUR INTERNET CONNECTION

Internet Connection

The result of Wan auto detection is: Dynamic IP (DHCP)

Internet Connection: Static IP [What is this?](#)

IP Address: 0.0.0.0 (is required field)

*Subnet Mask: 255.255.255.0

*Gateway Address: 0.0.0.0

*Primary DNS Server: 0.0.0.0

Secondary DNS Server: 0.0.0.0

Wireless Settings

Network Name (SSID): dlink

Security Mode: Disable Wireless Security (Not recommended)
 AUTO-WPA/WPA2(Recommended)

Network Key:

Auto generate network key

[Prev](#) [Next](#)

CONFIGURAÇÃO DO PRODUTO

ACESSE FACILMENTE O ASSISTENTE DE CONFIGURAÇÃO E O SERVIÇO mydlink

passo 3

Na página de "Configuração de Rede Atual", você verá que o status da INTERNET é "conectado".

EASY SETUP COMPLETE

After clicking the "Save" button, you need to provide your username and password to access the device when logging in next time.

Internet Settings

Internet Connection : Dynamic IP (DHCP) Status : **Connected**

Wireless Settings

Wireless Network Name (SSID) : dlink Status : **Unsecured** [Configure](#)

Security : Disabled

Your current wireless security settings are not safe. We recommend you configure wireless settings.

Device Info

User Name : admin

Password :

mydlink Account

You have not activated mydlink service Status : **Not Connected** [Configure](#)

Save my network settings

[Save](#)

PORTUGUÊS

passo 4

Se você não tiver registrado uma conta mydlink, por favor, clique em "configure" na seção "conta mydlink" e preencha o formulário de inscrição.

Clique em "Register"

Do you have mydlink account ?

Yes, I have a mydlink account.

No, I want to register and login with a new mydlink account.

Please fulfill the options to complete the registration.

E-mail Address (Account Name) : [What is this?](#)

Password :

Confirm Password :

Last name :

First Name :

Device User Name : admin

Device Password :

[I Accept the mydlink terms and conditions](#)

[Register](#) [Back](#)

CONFIGURAÇÃO DO PRODUTO

ACESSE FACILMENTE O ASSISTENTE DE CONFIGURAÇÃO E O SERVIÇO mydlink

Passo 5

Agora você pode ver a dica de que uma verificação de e-mail foi enviada. Abra um novo navegador para efetuar login da sua conta de e-mail para receber o e-mail de verificação. Uma vez que a fase de verificação de conta estiver concluída, clique em "next"

passo 6

Agora o roteador conseguiu conectar-se ao serviço mydlink. Você pode baixar o aplicativo "mydlink lite" do Android Market ou loja apple para começar a desfrutar do serviço mydlink!

PORTUGUÊS

CURRENT NETWORK SETTING

The current network settings and the connection status are displayed below. If you want to reconfigure your wireless settings, please click the "Configure" button. You can also enter advanced settings by clicking "Manual Setup".

Internet Settings	Internet Connection : Dynamic IP (DHCP)	Status : Connected
Wireless Settings	Network Name (SSID) : dlink	Status : Encryption Configure
	Security : Auto (WPA or WPA2) - Personal	
	Network Key : 12345678	
Device Info	User Name : admin	
	Password : admin	
mydlink Account	mydlink service is activated	Status : Connected Configure

Save my network settings

[Save](#)

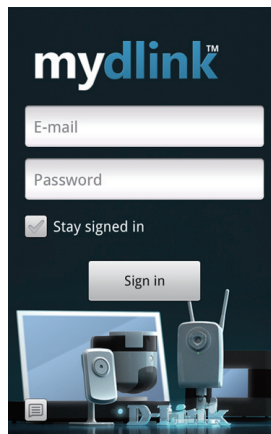

mydlink™

E-mail

Password

Stay signed in

Sign in

The login screen features a dark background with the mydlink logo at the top. Below the logo are two white input fields for 'E-mail' and 'Password'. A checkbox labeled 'Stay signed in' is checked. A 'Sign in' button is positioned below the checkbox. At the bottom, there is a small image of various D-Link networking devices, including a router, a power adapter, and a USB device.

RESOLUÇÃO DE PROBLEMAS

PROBLEMAS DE SETUP E CONFIGURAÇÃO

1. COMO FAÇO PARA CONFIGURAR MEU ROUTER DIR-605L, OU VERIFICAR MEU NOME DE REDE WIRELESS (SSID) E A CHAVE DE CRIPTOGRAFIA WIRELESS?

- Ligue o PC ao roteador usando um cabo Ethernet.
- Abra um navegador web e digite o endereço <http://dlinkrouter> ou <http://192.168.0.1>
- O nome de usuário padrão é 'admin'. A senha padrão é "(deixar o campo em branco).
- Se você tiver alterado a senha e não pode se lembrar, você precisará reconfigurar o roteador para definir a senha de volta para "(deixe o campo em branco).

2. COMO FAÇO PARA REDEFINIR MEU ROTEADOR DIR-605L ÀS CONFIGURAÇÕES DE FÁBRICA?

- Certifique-se de que o roteador está ligado.
- Pressione e segure o botão de reset na parte traseira do dispositivo por 20 segundos.

Nota: Reiniciar o roteador para o padrão de fábrica apagará as configurações atuais. Para reconfigurar as suas definições, faça o login no roteador, conforme descrito na questão 1 e em seguida, execute o Assistente de Configuração.

3. COMO FAÇO PARA ADICIONAR UM CLIENTE WIRELESS NOVO OU PC SE TIVER ESQUECIDO MEU NOME DA REDE WIRELESS (SSID) OU A CHAVE DE CRIPTOGRAFIA WIRELESS?

- Para conectar qualquer PC ao roteador sem fio, você vai precisar assegurar de que o nome da rede sem fio (SSID) e a chave de criptografia estejam corretos
- Use a interface de usuário web (como descrito na questão 1 acima) para verificar ou escolher as configurações sem fio.
- Certifique-se de anotar essas configurações para que você possa inseri-los em cada PC conectado sem fio. Você vai encontrar uma área dedicada na parte de trás deste documento para inserir informações importantes para uso futuro.

4. POE QUE EU NÃO CONSIGO UMA CONEXÃO COM A INTERNET?

- Para usuários ADSL, contacte o seu ISP (provedor de serviços de internet) para se certificar de que o serviço foi ativado / conectado e que seu nome de usuário e senha estão corretos.

SUORTE TÉCNICO

Caso tenha dúvidas na instalação do produto, entre em contato com o Suporte Técnico D-Link.

Acesse o site: www.dlink.com.br/suporte

PORTUGUÊS

包裝內容物

內容物



WIRELESS N 300 路由器
DIR-605L



電源供應器
變壓器



乙太網路線
將設備連接至您的網路



若有內容物遺漏，請儘快聯絡您購買的經銷商。

中
文

產品設定

安裝您的路由器

步驟一

將您的路由器擺設在靠近您的數據機和已上線的電腦，並放在一個阻隔物較少的位置來來讓無線訊號有較佳的涵蓋範圍。

步驟二

將連接至您的電腦的乙太網路線拔除並插入路由器背面的LAN埠，讓您的路由器直接連接至您的電腦。

步驟三

使用另一條乙太網路線，將一端連接至路由器背面的Internet埠，然後將另一端連至您的數據機。

步驟四

將電源供應器的一端插入您的路由器，另一端接至一個電源插座或延長線，然後確認電源指示燈已亮起。之後再參考以下基本網路設定的步驟。

產品設定

執行快速安裝精靈和mydlink服務

步驟一

當您的電腦已經連線至路由器，您只要開啟網頁瀏覽器您就會直接被導引至D-Link安裝精靈頁面，並且自動偵測到連線型態。

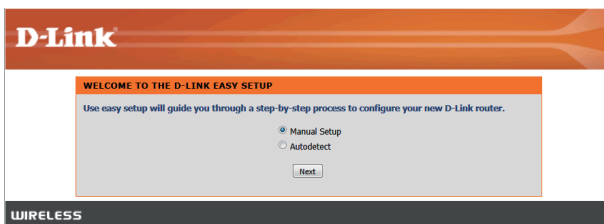
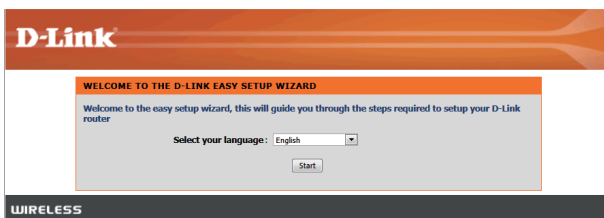

中
文

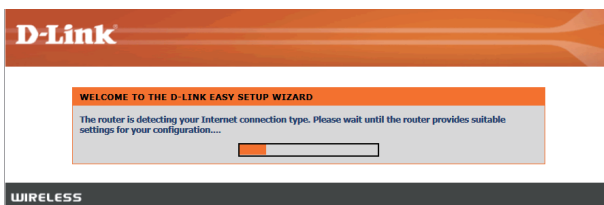

產品設定

執行快速安裝精靈和mydlink服務

步驟二

依照所偵測到的連線類型，跟隨精靈指示的步驟來設定您的網際網路連線。

D-Link

STEP 1: CONFIGURE YOUR INTERNET CONNECTION

Internet Connection

The result of Wan auto detection is: Dynamic IP (DHCP)

Internet Connection: Dynamic IP (DHCP) [What is this?](#)

Wireless Settings

Network Name (SSID): dlink

Security Mode: Disable Wireless Security (Not recommended)
 AUTO-WPA/WPA2(Recommended)

Network Key: Auto generate network key

STEP 1: CONFIGURE YOUR INTERNET CONNECTION

Internet Connection

The result of Wan auto detection is: Dynamic IP (DHCP)

Internet Connection: PPPoE [What is this?](#)

User Name: (is required field)

*Password:

*Confirm Password:

Wireless Settings

Network Name (SSID): dlink

Security Mode: Disable Wireless Security (Not recommended)
 AUTO-WPA/WPA2(Recommended)

Network Key:

Auto generate network key

STEP 1: CONFIGURE YOUR INTERNET CONNECTION

Internet Connection

The result of Wan auto detection is: Dynamic IP (DHCP)

Internet Connection: Static IP [What is this?](#)

IP Address: 0.0.0.0 (is required field)

*Subnet Mask: 255.255.255.0

*Gateway Address: 0.0.0.0

*Primary DNS Server: 0.0.0.0

Secondary DNS Server: 0.0.0.0

Wireless Settings

Network Name (SSID): dlink

Security Mode: Disable Wireless Security (Not recommended)
 AUTO-WPA/WPA2(Recommended)

Network Key:

Auto generate network key

產品設定

執行快速安裝精靈和mydlink服務

步驟三

在「目前設定」的畫面內，您將可以看到連線狀態為「已連上網際網路」。

目前設定

這是目前的網路設定與目前的網際網路連線狀態。如果您想要重新設定無線網路，請按「設置」。您也可以藉由「手動設定模式」按鈕，進入進階設定。

設備網際網路設定

設備的網際網路(Internet)連線方式：動態IP位址(DHCP) 狀態：已連上網際網路

無線設定

無線網路名稱(SSID)：dlink 狀態：不安全 [設定](#)

安全模式：停用

您目前的無線設定並不安全，建議您重新設定無線網路。

設備資訊

用戶名稱：admin
密碼：

mydlink帳號資訊

您尚未設定mydlink帳號 狀態：尚未連線 [設定](#)

儲存我的網路設定

[儲存](#)

步驟四

若您還沒註冊一個mydlink帳號，請點選下方位於mydlink區塊的「設定」鈕並完成註冊表格。

按下「註冊」按鈕。

設定您的mydlink帳號

你現在有mydlink帳號嗎？

是的，我有mydlink帳號

沒有，我想要註冊一個我的mydlink帳號。

請填寫以下資訊來註冊mydlink帳號

電子郵件(mydlink帳號名稱)： [這是什麼](#)

密碼： (至少輸入六個字元)

重新輸入密碼：

姓：

名：

路由器的使用者名稱： admin

路由器的密碼：

我同意mydlink服務條文與相關條款

[註冊](#) [返回](#)

產品設定

執行快速安裝精靈和mydlink服務

步驟五

您將可以看到確認電郵已寄出的提示，請至您的e-mail信箱讀取此確認信件。
一旦確認步驟完成，請點選「next」

步驟六

您的路由器已成功連線至mydlink服務，您可以從Android Market或Apple Store下載mydlink lite的app並開始使用mydlink服務了！



中
文



疑難排解

設定和安裝問題

1. 在不使用光碟的情況下我該如何設定 DIR-605L，或是檢視我的無線網路名稱(SSID)與無線網路金鑰？

- 使用網路線來連接您的電腦與DIR-605L。
- 開啟網頁瀏覽器並在網址內輸入 <http://dlinkrouter> 或 <http://192.168.0.1>。
- 預設的使用者名稱為admin，預設無密碼(將欄位留成空白)。
- 若您已忘記之前更改過的密碼，您可以將路由器回復成原廠預設值來將密碼清除。

2. 如何將DIR-605L回復成原廠預設值？

- 確認路由器已接上電源且電源指示燈已亮起。
- 用迴紋針等細物插入路由器背面的reset孔約20秒。

注意: 將路由器回復成原廠預設值將會將目前的設定全部清除，可依照問題1的內容來登入路由器，執行設定精靈來重新設定。

3. 若已忘記無線網路名稱(SSID)或無線網路金鑰時，新的無線裝置或電腦該如何連上？

- 每一個想要透過無線連線的裝置，需確認連線時是使用正確的無線網路名稱(SSID)和網路金鑰。
- 利用網頁介面進入DIR-605L的設定畫面(依問題1的回答內容)來查看或設定您的無線網路。
- 請確認您已經將無線相關的設定記下，讓您未來可以在新的裝置內使用這些資料來使用無線網路。

4. 為何我無法連通網際網路？

- 若您為Cable寬頻使用者，請確認在設定精靈的執行過程中已點選複製MAC位址的按鈕(或已手動輸入MAC位址)，並請確認網路服務可正常使用。
- 若您為xDSL使用者，請確認網路服務可以正常使用，且輸入的連線使用者名稱和密碼是正確的。
- 若您為固定IP使用者，請確認網路服務可以正常使用，且輸入的IP位址資料是正確的。

D-Link 友訊科技 台灣分公司 技術支援資訊

如果您還有任何本使用手冊無法協助您解決的產品相關問題，台灣地區用戶可以透過我們的網站、電子郵件或電話等方式與D-Link台灣地區技術支援工程師聯絡。

D-Link 免付費技術諮詢專線

0800-002-615

服務時間：週一至週五，早上9:00到晚上9:00

(不含周六、日及國定假日)

網 站：<http://www.dlink.com.tw>

電子郵件：dssqa_service@dlink.com.tw

如果您是台灣地區以外的用戶，請參考**D-Link**網站，全球各地分公司的聯絡資訊以取得相關支援服務。

產品保固期限、台灣區維修據點查詢，請參考以下網頁說明：

<http://www.dlink.com.tw>

產品維修：

使用者可直接送至全省聯強直營維修站或請洽您的原購買經銷商。

ISI KEMASAN

ISI

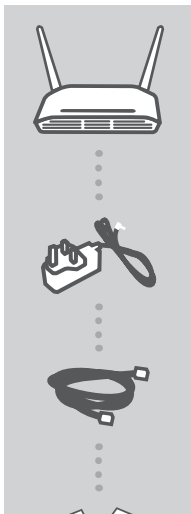

WIRELESS N 300 CLOUD ROUTER
DIR-605L

ADAPTOR DAYA
ADAPTOR

KABEL ETHERNET
MENGHUBUNGAN PERANGKAT DENGAN
JARINGAN ANDA

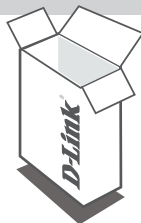

Jika terdapat salah satu item yang hilang dari kemasan, harap hubungi reseller anda.

BAHASA INDONESIA

PENGATURAN PRODUK

INSTAL ROUTER ANDA

Langkah 1

Posisikan router anda dekat dengan modem dan komputer yang sudah online. Pastikan anda menempatkan router ini di daerah terbuka untuk bisa mencapai jangkauan nirkabel yang lebih baik.

Langkah 2

Cabut kabel Ethernet dari modem yang terhubung ke computer anda. Hubungkan ke port LAN dengan label 1 pada bagian belakang router anda. Router sekarang terhubung ke komputer Anda.

Langkah 3

Gunakan kabel Ethernet baru dan pasang salah satu ujung dari kabel tersebut ke port berlabel INTERNET di bagian belakang router. Colokkan ujung lainnya dari kabel tersebut ke port Ethernet pada modem Anda.

Langkah 4

Hubungkan adaptor listrik yang disediakan ke port power di bagian belakang router kemudian hubungkan steker ke stopkontak. Verifikasi bahwa lampu daya menyala. Di bawah ini adalah pengaturan dasar jaringan.

PENGATURAN PRODUK

JALANKAN “EASY SETUP WIZARD” DAN SERVIS mydlink

Langkah 1

Dari PC yang terhubung ke router, buka web browser maka anda akan diarahkan ke halaman Setup Wizard D-Link, yang mendeteksi tipe koneksi INTERNET.

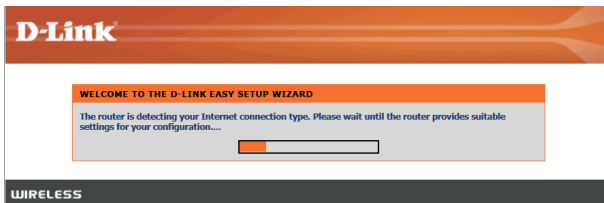
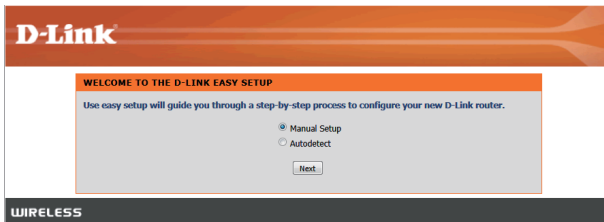
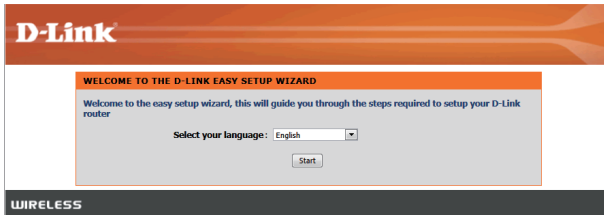

PENGATURAN PRODUK

JALANKAN “EASY SETUP WIZARD” DAN SERVIS mydlink

Langkah 2

Menurut hasil deteksi, ikuti petunjuk pada layar untuk mengkonfigurasi pengaturan INTERNET anda.

D-Link

STEP 1: CONFIGURE YOUR INTERNET CONNECTION

Internet Connection

The result of Wan auto detection is: Dynamic IP (DHCP)

Internet Connection: Dynamic IP (DHCP) [What is this?](#)

Wireless Settings

Network Name (SSID): dlink

Security Mode: Disable Wireless Security (Not recommended)
 AUTO-WPA/WPA2(Recommended)

Network Key: Auto generate network key

WIRELESS

STEP 1: CONFIGURE YOUR INTERNET CONNECTION

Internet Connection

The result of Wan auto detection is: Dynamic IP (DHCP)

Internet Connection: PPPoE [What is this?](#)

User Name: (is required field)

*Password:

*Confirm Password:

Wireless Settings

Network Name (SSID): dlink

Security Mode: Disable Wireless Security (Not recommended)
 AUTO-WPA/WPA2(Recommended)

Network Key: Auto generate network key

STEP 1: CONFIGURE YOUR INTERNET CONNECTION

Internet Connection

The result of Wan auto detection is: Dynamic IP (DHCP)

Internet Connection: Static IP [What is this?](#)

IP Address: 0.0.0.0 (is required field)

*Subnet Mask: 255.255.255.0

*Gateway Address: 0.0.0.0

*Primary DNS Server: 0.0.0.0

Secondary DNS Server: 0.0.0.0

Wireless Settings

Network Name (SSID): dlink

Security Mode: Disable Wireless Security (Not recommended)
 AUTO-WPA/WPA2(Recommended)

Network Key: Auto generate network key

PENGATURAN PRODUK

JALANKAN "EASY SETUP WIZARD" DAN SERVIS mydlink

Langkah 3

Di halaman "CURRENT NETWORK SETTING", Anda akan melihat status INTERNET adalah "CONNECTED".

EASY SETUP COMPLETE

After clicking the "Save" button, you need to provide your username and password to access the device when logging in next time.

Internet Settings

Internet Connection : Dynamic IP (DHCP) Status : **Connected**

Wireless Settings

Wireless Network Name (SSID) : dlink Status : **Unsecured** [Configure](#)

Security : Disabled

Your current wireless security settings are not safe. We recommend you configure wireless settings.

Device Info

User Name : admin

Password :

mydlink Account

You have not activated mydlink service Status : **Not Connected** [Configure](#)

Save my network settings

[Save](#)

Langkah 4

Jika Anda belum terdaftar pada account mydlink, silakan klik "configure" pada bagian "mydlink account" dan lengkapi formulir pendaftaran.

Klik "Register"

Do you have mydlink account ?

Yes, I have a mydlink account.

No, I want to register and login with a new mydlink account.

Please fulfill the options to complete the registration.

E-mail Address (Account Name) : [What is this?](#)

Password :

Confirm Password :

Last name :

First Name :

Device User Name : admin

Device Password :

I Accept the mydlink terms and conditions

[Register](#) [Back](#)

PENGATURAN PRODUK

JALANKAN "EASY SETUP WIZARD" DAN SERVIS mydlink

Langkah 5

Sekarang Anda dapat melihat petunjuk yang mengatakan bahwa e-mail verifikasi telah dikirim. Buka browser baru dan login pada account e-mail anda untuk menerima e-mail verifikasi. Setelah fase verifikasi account selesai, klik "next"

Langkah 6

Sekarang router sudah berhasil tersambung ke layanan mydlink. Anda dapat mendownload Aplikasi "mydlink lite" dari Android Market atau Apple Store untuk memulai menikmati layanan mydlink!

CURRENT NETWORK SETTING

The current network settings and the connection status are displayed below. If you want to reconfigure your wireless settings, please click the "Configure" button. You can also enter advanced settings by clicking "Manual Setup".

Internet Settings
Internet Connection : Dynamic IP (DHCP) Status : **Connected**

Wireless Settings
Network Name (SSID) : dlink Status : **Encryption**
Security : Auto (WPA or WPA2) - Personal
Network Key : 12345678

Device Info
User Name : admin
Password : admin

mydlink Account
mydlink service is activated Status : **Connected**

Save my network settings
Save

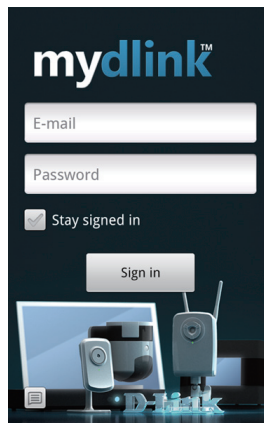

PENANGANAN MASALAH

MASALAH PENGATURAN DAN KONFIGURASI

1. BAGAIMANA SAYA DAPAT MENGONFIGURASI ROUTER DIR-605L SAYA, ATAU MEMANTAU NAMA JARINGAN NIRKABEL (SSID) DAN KUNCI ENKRIPSI NIRAKABEL?

- Hubungkan PC Anda ke router dengan menggunakan kabel Ethernet.
- Buka web browser dan masukkan alamat <http://dlinkrouter> atau <http://192.168.0.1>
- Username default adalah 'admin'. Password default dibiarkan kosong.
- Jika Anda telah mengubah password dan tidak dapat mengingatnya, Anda akan perlu untuk me-reset router untuk mengembalikan password menjadi kosong.

2. BAGAIMANA SAYA ME-RESET ROUTER DIR-605L SAYA UNTUK MENGEMBALIKAN KE PENGATURAN DEFAULT PABRIK?

- Pastikan router dinyalakan.
- Tekan dan tahan tombol reset pada bagian belakang perangkat hingga 20 detik.

Catatan: Me-reset router ke default pabrik akan menghapus pengaturan konfigurasi anda. Untuk kembali mengkonfigurasi pengaturan Anda, login ke router seperti yang dijelaskan dalam pertanyaan 1, kemudian jalankan Setup Wizard.

3. BAGAIMANA CARA SAYA MENAMBAHKAN KLIEN BARU ATAU WIRELESS PC JIKA SAYA TELAH MELUPAKAN NAMA JARINGAN NIRKABEL (SSID) MAUPUN KUNCI ENKRIPSI NIRAKABELNYA?

- Setiap PC yang perlu terhubung ke router nirkabel, perlu anda pastikan untuk menggunakan SSID dan kunci enkripsi yang benar.
- Gunakan antarmuka pengguna berbasis web (seperti yang dijelaskan dalam pertanyaan 1 di atas) untuk memeriksa atau memilih setelah nirkabel Anda.
- Pastikan Anda menuliskan pengaturan ini sehingga Anda dapat memasukkan mereka ke dalam setiap PC yang terhubung secara nirkabel. Anda akan menemukan area khusus di bagian belakang dokumen ini. Informasi penting ini untuk penggunaan masa depan.

4. MENGAPA SAYA TIDAK BISA MENDAPATKAN KONEKSI INTERNET?

- Untuk pengguna ADSL silahkan hubungi ISP anda untuk memastikan bahwa layanan telah diaktifkan/dihubungkan oleh ISP dan username serta password ISP anda sudah benar.

DUKUNGAN TEKNIS

Update perangkat lunak dan dokumentasi pengguna dapat diperoleh pada situs web D-Link.
Dukungan Teknis untuk pelanggan:

Dukungan Teknis D-Link melalui telepon:

Tel: +62-21-5731610

Dukungan Teknis D-Link melalui Internet:

Email : support@dlink.co.id

Website : <http://support.dlink.co.id>

NOTES

WIRELESS NETWORK REMINDER

Wireless Network Name (SSID)

Wireless Network Password