

# Triple Polarization Directional Antenna

## Electrical specification

Frequency range	2400 - 2500 MHz	5150 - 5875MHz
Gain	11 dBi	12 - 14 dBi
VSWR	2.0 : 1 (max.)	2.0 : 1 (max.)
Polarization	Linear, Horizontal & Vertical X 2	Linear, $\pm 45^\circ$ & Vertical
Horizontal HPBW	$35^\circ - 45^\circ$	$19^\circ - 22^\circ$
Vertical HPBW	$36^\circ - 38^\circ$	$25^\circ - 31^\circ$
Input impedance	50 ohm	
Connector	N Jack x 3	
Power handling	10 W (cw)	6 W (cw)



## Environmental & Mechanical Characteristics

Survival wind speed	216 Km/hr
Temperature	$-40^\circ\text{C}$ to $+80^\circ\text{C}$
Humidity	95 % @ $55^\circ\text{C}$
Radome color	White
Radome material	ABS, UV Resistant
Weight	1.72 Kg
Dimensions	360 x360 x 40 mm
Dustproof/Waterproof	IP-67
Mounting kit	Pole Mount & Wall Mount

2.4GHz

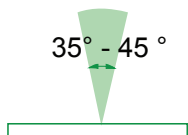

Horizontal coverage

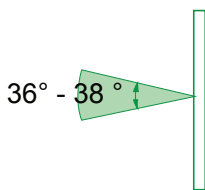

Vertical coverage

5GHz

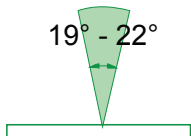

Horizontal coverage

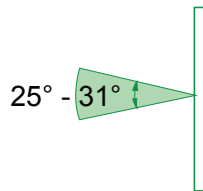

Vertical coverage

## Wall mount

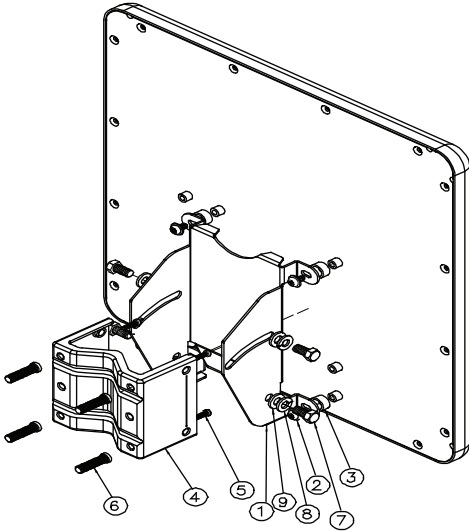

- |                    |      |
|--------------------|------|
| ① Mounting base    | 1pcs |
| ② M4*8 Screw+S/W+W | 4pcs |
| ③ Space Keeper     | 4pcs |
| ④ M-Shape Mounting | 1pcs |
| ⑤ Pole mount clip  | 1pcs |
| ⑥ M6*60 screw      | 2pcs |
| ⑦ M6*16 screw      | 4pcs |
| ⑧ M6 S/W           | 4pcs |
| ⑨ M6 W             | 4pcs |

## Pole mount

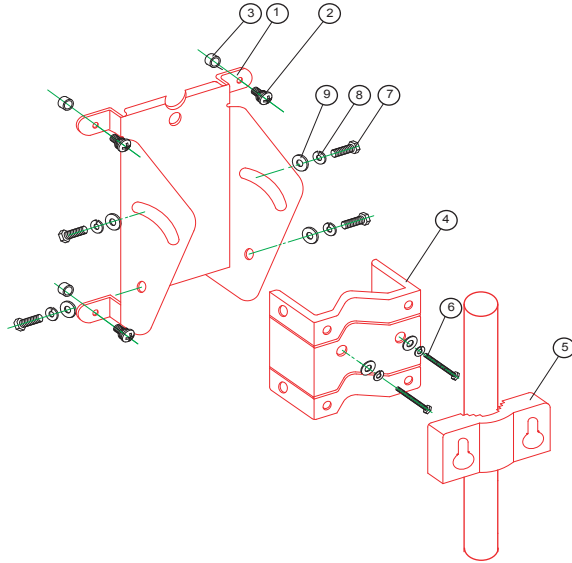

- |                    |      |
|--------------------|------|
| ① Mounting base    | 1pcs |
| ② M4*8 Screw+S/W+W | 4pcs |
| ③ Space keeper     | 4pcs |
| ④ M-Shape mounting | 1pcs |
| ⑤ Screw 3/4"       | 4pcs |
| ⑥ Wall tiger 1/4"  | 4pcs |
| ⑦ M6*16 screw      | 4pcs |
| ⑧ M6 S/W           | 6pcs |
| ⑨ M6 W             | 6pcs |

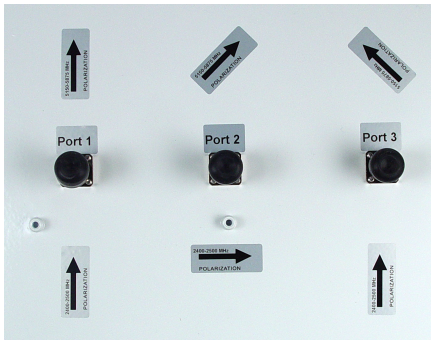

For 11n Access Point with 2X2 MIMO design, connecting port 2 and port 3 is suggested.

## Package Contents:

- ANT 70-1400N Antenna
- 50cm extension cable
- Mounting Kit
- Waterproof tape
- Quick Installation Guide

## Radiation Pattern

### Port 1 (H-Plane)

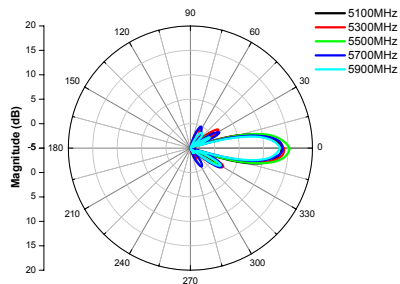
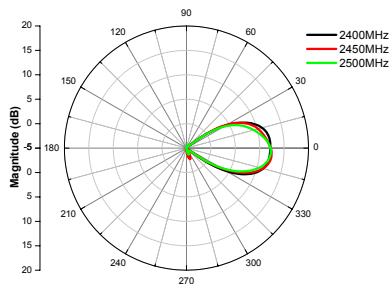

### Port 1 (V-Plane)

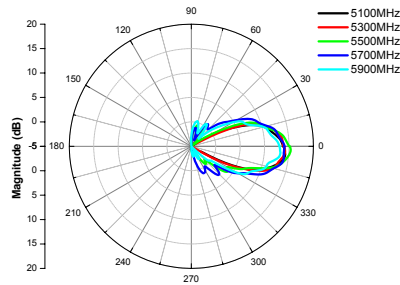
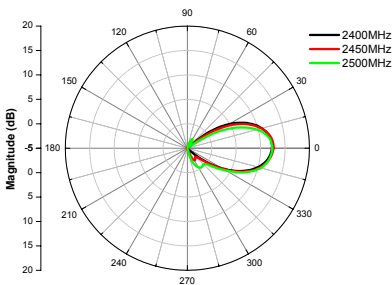

### Port 2 (H-Plane)

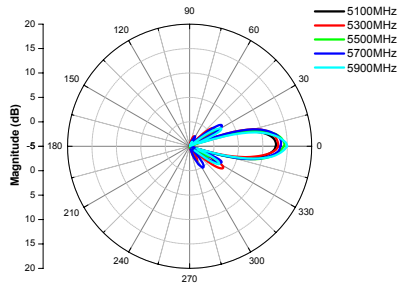
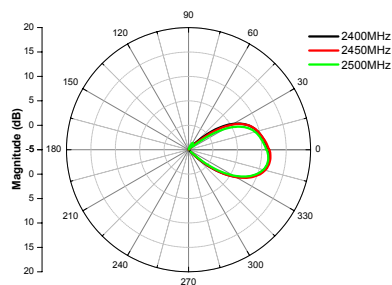

## Radiation Pattern

### Port 2 (V-Plane)

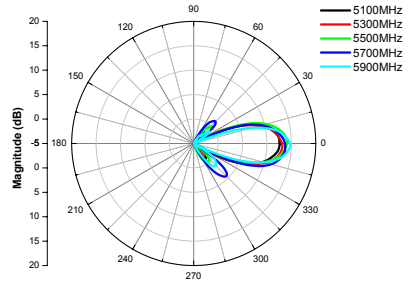
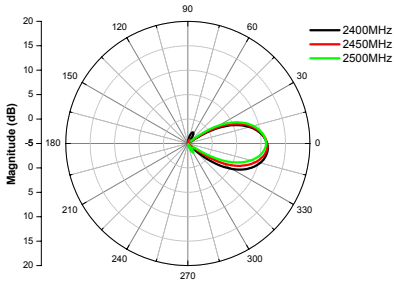

### Port 3 (H-Plane)

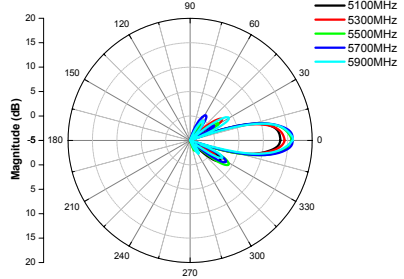
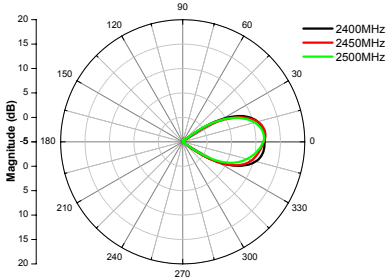

### Port 3 (V-Plane)

