

# 20000mAh Power Bank

## Quick Start Guide

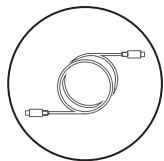

**D-Link**

DPP-201

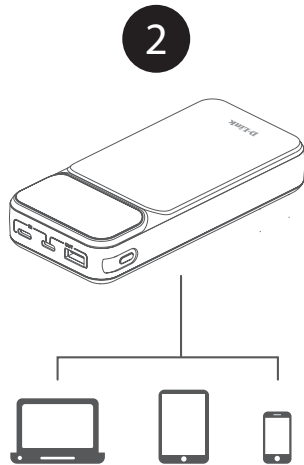
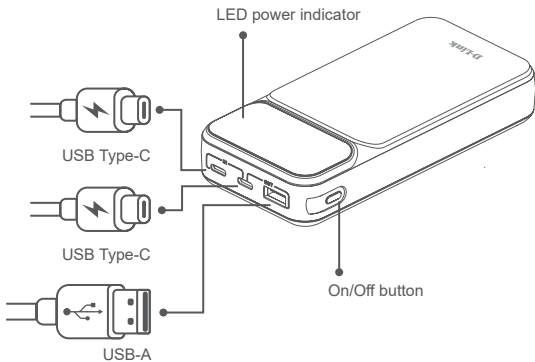
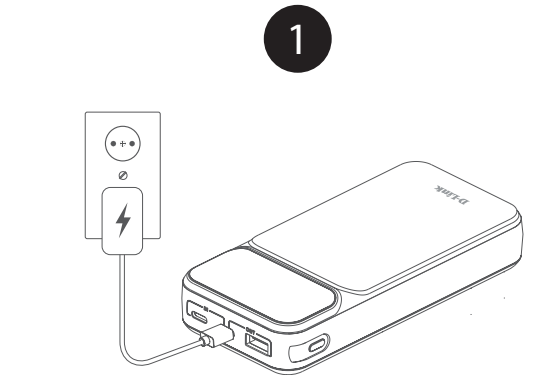

### FCC Warning

This device complies with Part 15 of the FCC Rules. Operation is subject to the following two conditions:  
(1) this device may not cause harmful interference, and  
(2) this device must accept any interference received, including interference that may cause undesired operation.



<https://support.dlink.com.au/>



<https://www.dlink.com.au/contactus>

|                    |                 |             |
|--------------------|-----------------|-------------|
| Battery Capacity   | Capacity        | 20,000mAh   |
| Input              | USB-C1          | 65W         |
|                    | USB-C2          | 65W         |
| Output Single Port | USB-C1          | 65W         |
|                    | USB-C2          | 65W         |
|                    | USB-A           | 22.5W       |
|                    | USB-C1 + C2     | 35W + 20W   |
| Output Dual Ports  | USB-C1 + A      | 35W + 22.5W |
|                    | USB-C2 + A      | 15W         |
|                    | USB-C1 + C2 + A | 35W + 15W   |

| Multi-function Button               | Description  |
|-------------------------------------|--|
| Click Button                        | <ul style="list-style-type: none"><li>Turn on LED</li><li>The LED will turn off automatically if there is no load after 32 seconds</li></ul> |
| Double Click Button                 | <ul style="list-style-type: none"><li>Turn off the power bank</li></ul>  |
| Press and hold Button for 1 seconds | <ul style="list-style-type: none"><li>Switch discharge mode between fast discharging and normal discharging</li></ul>                        |

| LED             | Description  |
|-----------------|--|
| Digits 0 to 100 | Discharge: <ul style="list-style-type: none"><li>Solid: The remaining battery capacity over 5%</li><li>Blinking: The remaining battery capacity less than 5%</li></ul>   |
|                 | Charge: <ul style="list-style-type: none"><li>The LED will turn off if there is no load after 32 seconds</li><li>The last digit number blinking: Charge the power bank</li><li>Solid 100%: The power bank is fully charged</li></ul>   |
|                 | Green Lighting icon  |
|                 | The power bank in fast charging or fast discharging mode   |
| E1~E7           | <ul style="list-style-type: none"><li>E1: USB-C1 over current protection</li><li>E2: USB-C1 over voltage protection</li><li>E3: USB-C1 under-voltage protection</li><li>E4: USB-C2 or USB-A over current protection</li><li>E5: USB-C2 or USB-A over voltage protection</li><li>E6: USB-C2 or USB-A under-voltage protection</li><li>E7: Overheat protection</li></ul> |
|                 | Troubleshooting: <ul style="list-style-type: none"><li>E1~E6: Please click button or reconnect devices to fix this issue</li><li>E7: Please don't use the battery and wait until it cools down</li></ul>   |
|                 |  |
|                 |  |
|                 |  |
|                 |  |
|                 |  |