

How to setup DSL-2885A modem router
for VDSL connection
(NBN FTTB / FTTN with PPPoE authentication)

This document details how to setup your modem/router for VDSL connection

Step 1. Open your Internet browser e.g. Internet Explorer, Firefox, Chrome, Safari, etc. and enter the IP address of your D-Link modem in the **address bar**: <http://192.168.1.1>.

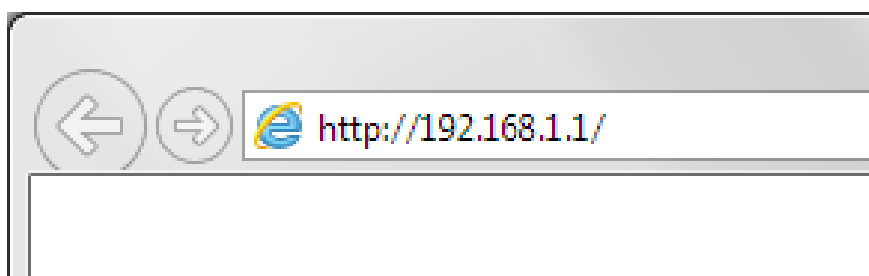

Step 2. When prompted type in the Username and Password, enter the validation code displayed on your page and then click on the “Log In” button.

If you have not changed the password for the modem administration, the factory settings are:

Password: admin

A screenshot of the D-Link modem administration page. At the top, the D-Link logo is on the left, and to its right are the following details: 'Model Name: DSL-2885A', 'Hardware Version: A1', 'Firmware Version: 1.00.05', and 'Language: English' with a dropdown arrow. Below this header is a central login box. Inside the box, the text 'Admin Password:' is above a text input field containing a single vertical bar. Below the input field is a teal 'Log In' button. At the bottom of the page, there is a link: 'To access your storage with SharePort Web Access, [click here](#).'

If you cannot recall the password you assigned to your modem you will need to reset the modem to factory defaults by pressing the reset button for 10 seconds. Please note that this will revert all the settings in the modem to factory settings and you will have to reconfigure it with your Internet settings and Wireless security. Make sure you have your Internet account details (given by your Internet Provider) handy.

After logging in you will be presented with the modem's Setup Wizard configuration page. If the Setup Wizard doesn't appear automatically, then you can initiate the Setup Wizard by clicking on **Settings > Wizard**.

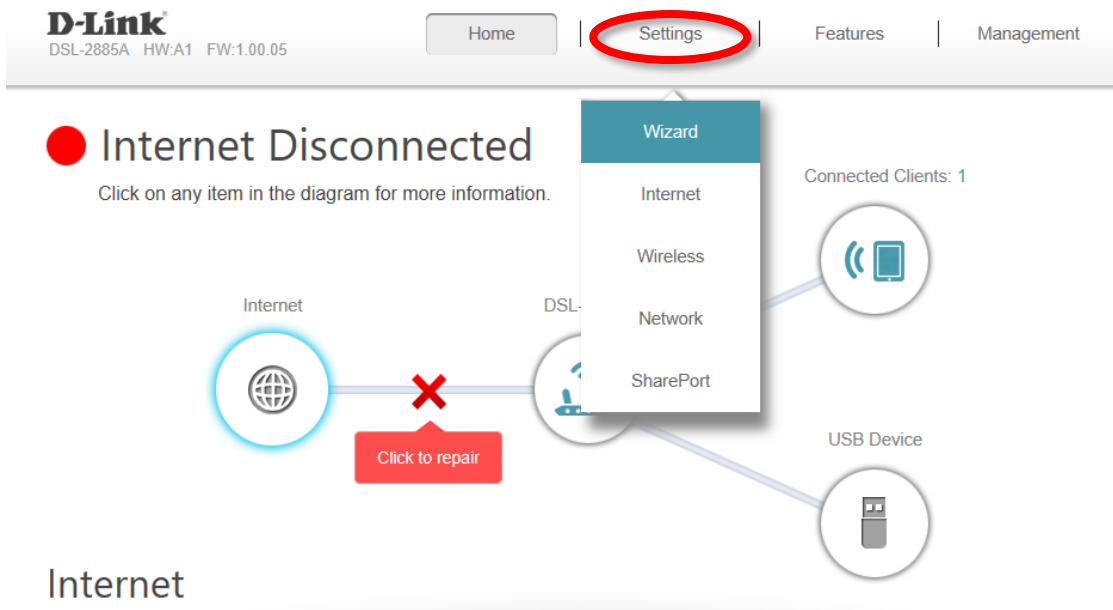

Step 3. Once the Setup Wizard configuration page is up, click Next and follow the Setup Wizard.

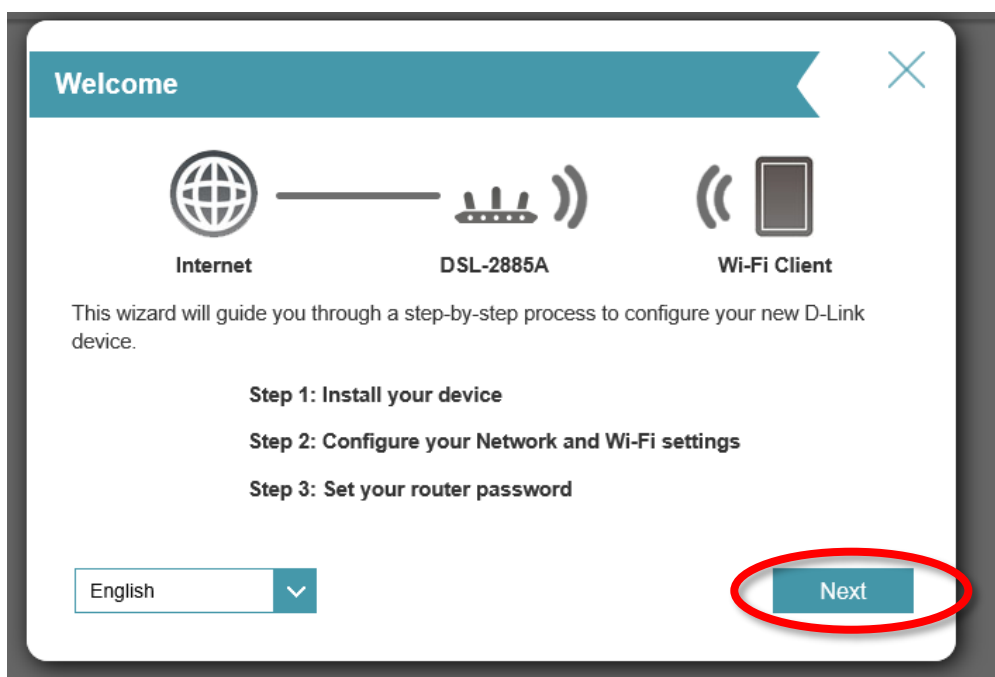

For VDSL connections select **WAN Access Type** as **VDSL, Australia**, followed by selecting **ISP** as (**Not Listed**).

Set the **VLAN ID (VID)** as advised by your Internet Provider. Some providers require VLAN ID to be set to specific value, otherwise please leave as zero.

Proceed by clicking Next.

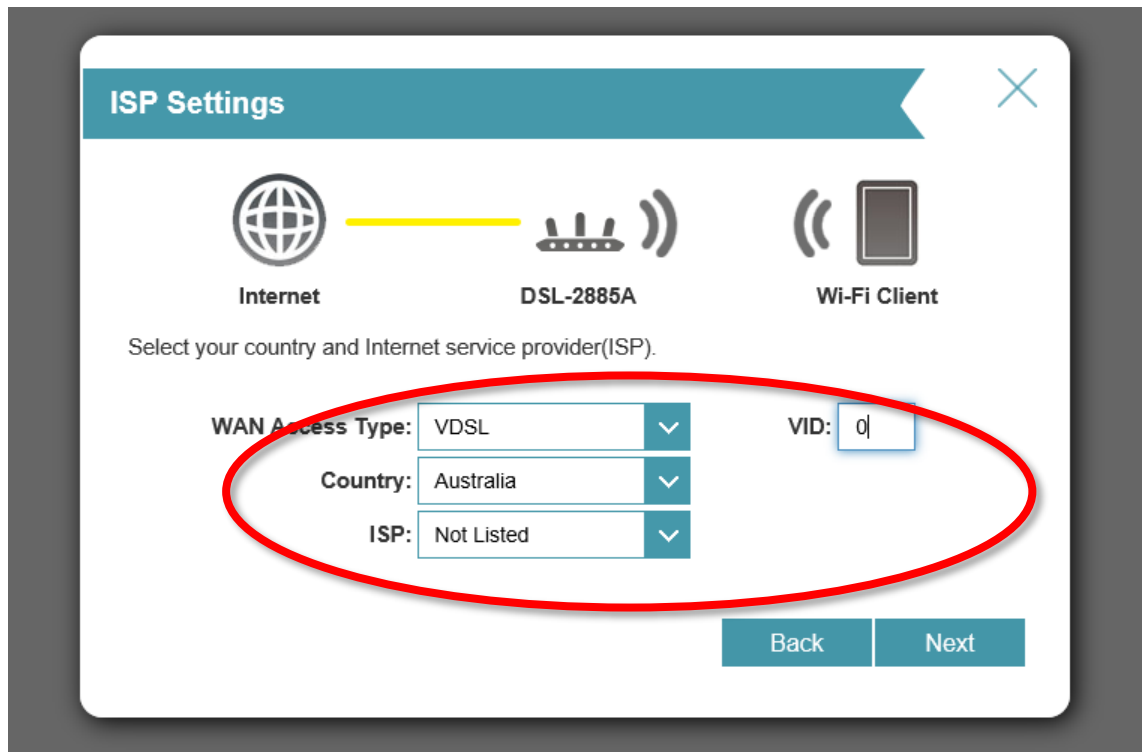

The image shows the 'ISP Settings' configuration screen. At the top, there are three icons: 'Internet' (globe), 'DSL-2885A' (DSL modem), and 'Wi-Fi Client' (phone). Below these icons, the text reads: 'Select your country and Internet service provider(ISP)'. The configuration fields are: 'WAN Access Type' set to 'VDSL', 'Country' set to 'Australia', and 'ISP' set to 'Not Listed'. A 'VID' field contains the value '0'. A red oval highlights the 'WAN Access Type', 'Country', and 'ISP' fields. At the bottom right, there are 'Back' and 'Next' buttons.

Step 4. Enter your full Username and Password as suggested by your Internet Service Provider. Username is normally your e-mail address, for example username@provider.com.au

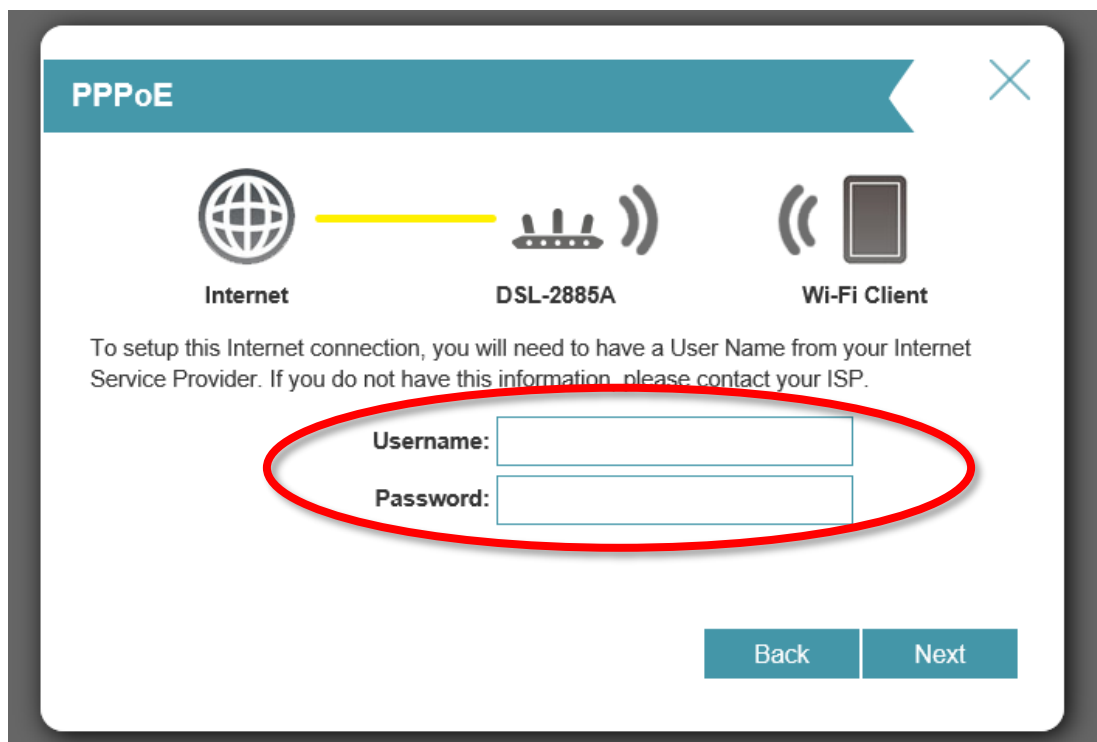

The image shows the 'PPPoE' configuration screen. At the top, there are three icons: 'Internet' (globe), 'DSL-2885A' (DSL modem), and 'Wi-Fi Client' (phone). Below these icons, the text reads: 'To setup this Internet connection, you will need to have a User Name from your Internet Service Provider. If you do not have this information, please contact your ISP.'. The configuration fields are: 'Username:' and 'Password:'. A red oval highlights the 'Username:' and 'Password:' fields. At the bottom right, there are 'Back' and 'Next' buttons.

Step 5. Configure and setup your Wireless Network:

Give your Wireless Network a name for each 2.4 GHz and 5.0 GHz wireless networks and assign a secure password.

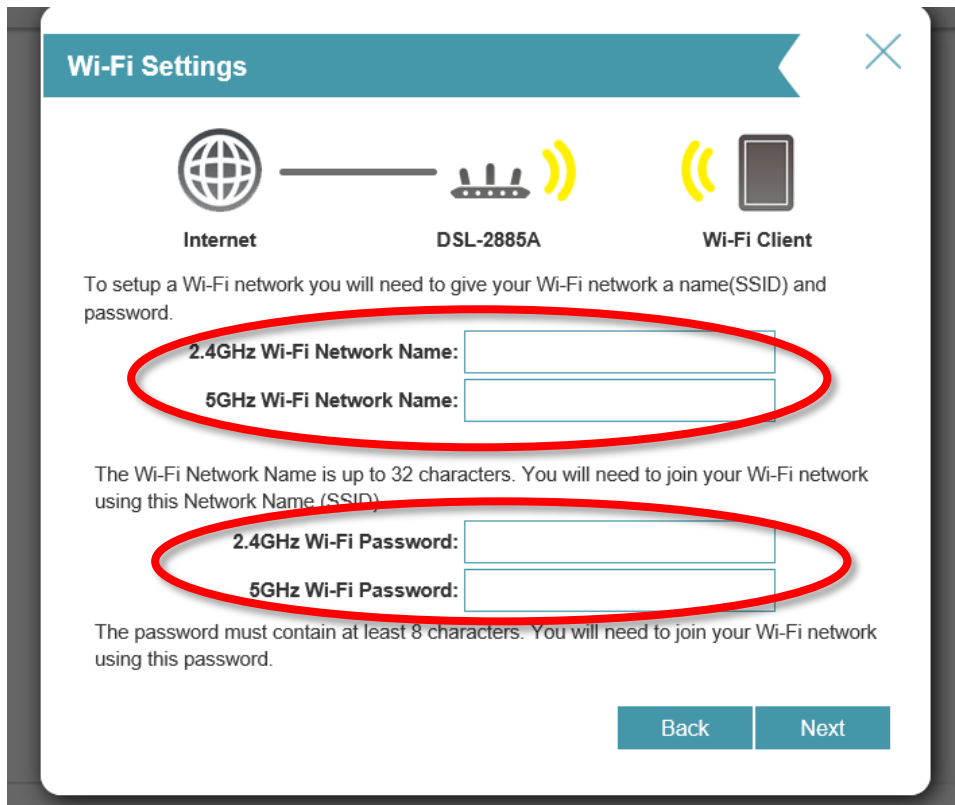

Step 6. Protect your modem router from unauthorised access by assigning a secure password.

It is recommended to change the default “admin” password to a secure password which needs to be a minimum of 8 characters long.

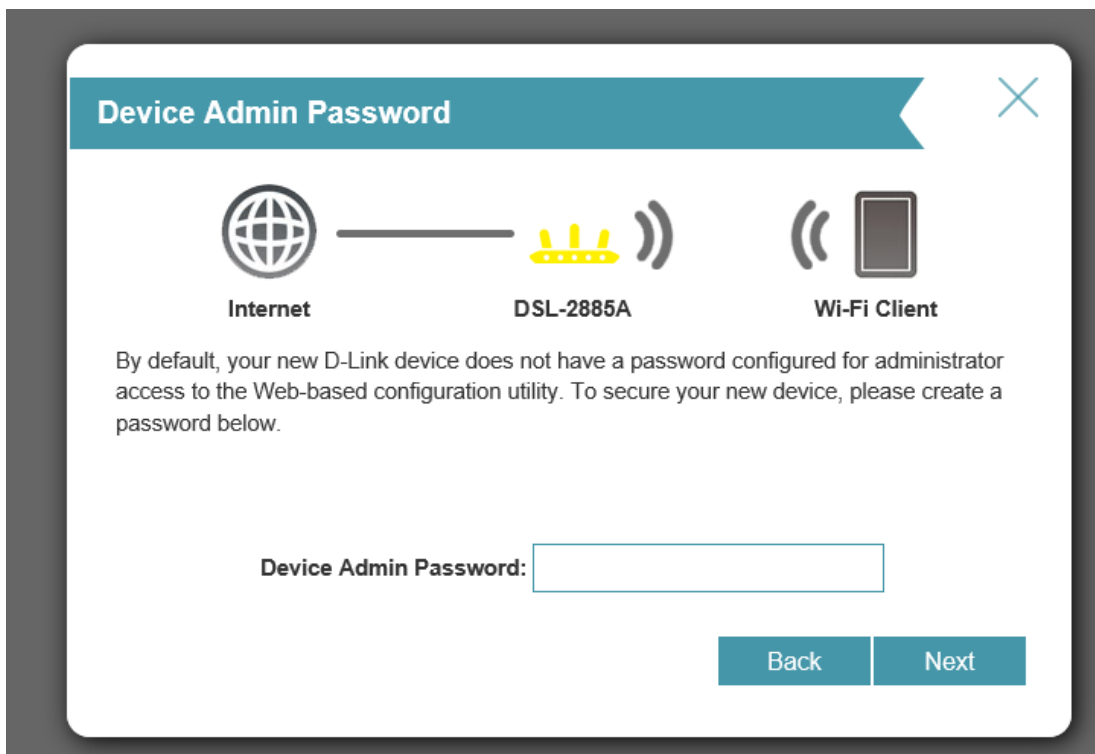

Step 7. A summary of the connection and password settings are shown on the next step. Confirm and proceed by clicking Next.

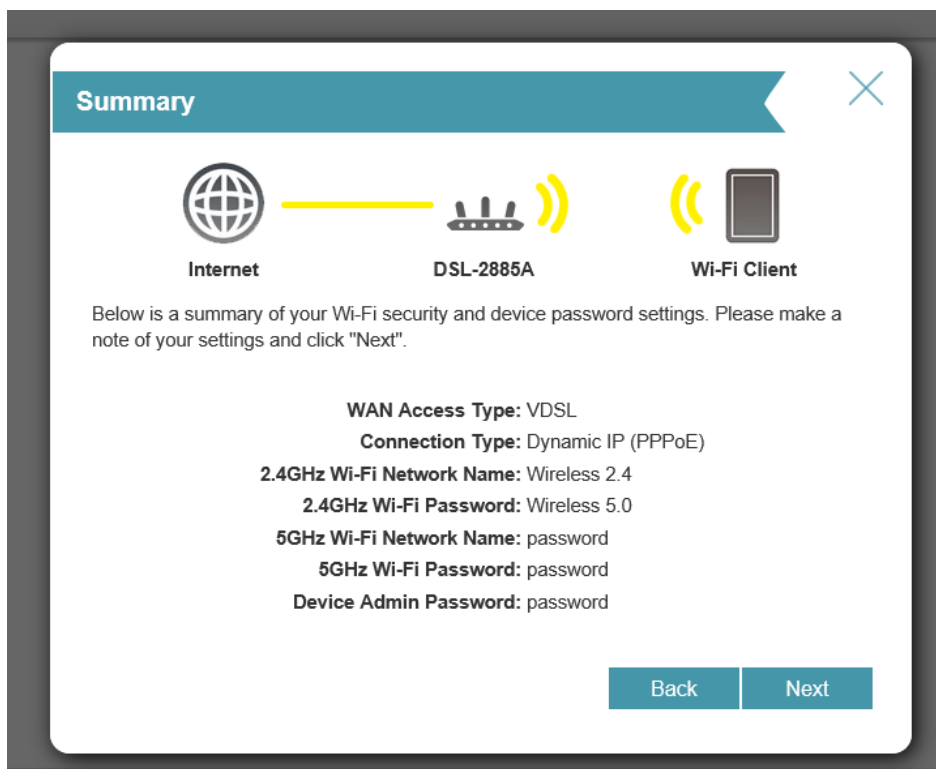

Step 8. Congratulations – The setup is Complete – Click Finish

