

HIGH PERFORMANCE
FASTER
READ/WRITE SPEEDS
GIGABIT CONNECTIVITY

1TB

HARD DISK DRIVE
INCLUDED



ShareCenter™



SHARECENTER PULSE

ADD SATA DRIVES WITH EASE*

Insert up to two internal 3.5-inch SATA hard drives by simply sliding them in – no tools or cables needed

BACK UP AND PROTECT FILES

Protect your important files using RAID 1 technology to automatically copy data onto both hard drives¹

WEB FILE SERVER

Access your personal files securely and remotely over the Internet from anywhere

SAFELY SHARE DIGITAL FILES LOCALLY AND OVER THE INTERNET

The ShareCenter™ Pulse 2-Bay Network Storage, when used with internal SATA drives*, enables users to share documents, files, and digital media such as music, photos, and videos with other users on a home or office network. Remotely accessing files through the Internet is also possible using the built-in secure FTP server and web file server. Keep data safe by giving rights to specific users or groups and assign them to folders with specific read/write permissions. This function is ideal for the home, where children's access can be restricted to only age-appropriate materials.

STREAM DIGITAL MEDIA CONTENT WITH BUILT-IN MEDIA SERVER

Back up your digital media files to the ShareCenter Pulse for safekeeping, and enjoy the benefits of the built-in UPnP AV media server. Stream digital content to compatible media players such as the PlayStation® 3, Microsoft® Xbox 360™, and D-link's MediaLounge product line.²

ACCESS YOUR PERSONAL FILES FROM ANYWHERE

The ShareCenter Pulse includes a web file server which allows you to download your documents, photos, and other multimedia files from anywhere. Once configured, simply log into your ShareCenter using the friendly web user interface to view a listing of available files. A convenient USB port on the front of the ShareCenter can be used to attach external USB storage drives, USB printers, or an Uninterruptible Power Supply (UPS) for monitoring.

ENJOY PERFORMANCE, PROTECTION, AND FLEXIBILITY

The availability of four different hard drive modes (Standard, JBOD, RAID 0, RAID 1) allows users to choose the configuration best suited to their needs. Standard mode creates two separately accessible hard drives. JBOD combines both drives to create a single, easy to use volume. RAID 0 combines both drives in a "striped" configuration, which provides the highest performance when using a Gigabit Ethernet connection. RAID 1 creates a copy of your data on both drives, providing maximum protection; if one drive fails while configured as RAID 1, the unaffected drive continues to function as a single drive until the failed drive is replaced. The new drive will then be re-mirrored, allowing the ShareCenter Pulse to return to its full level of protection.

*1TB SATA drive included with the ShareCenter Pulse, second SATA hard disk drive must be purchased separately.

WHAT THIS PRODUCT DOES

The ShareCenter™ Pulse, when used with internal SATA drives, enables homes and offices to share documents, music, photos, and videos across the network and on the Internet, so family members, friends, or employees can easily access them. This device also allows for the creation of a central network point for backing up files and the built-in RAID 1 mirroring technology protects these files from drive failure. This device can be used to stream music, photos, and videos to UPnP AV compatible network media players.²

ROBUST SOFTWARE INCLUDED

The included CD contains D-Link's Setup Wizard and Easy Search Utility, which allows users to locate the ShareCenter Pulse anywhere on the network. Once located, they can use the utility to map the hard drive(s) so they will appear in "My Computer" on their PC. Backup software is also included on the CD, allowing users to backup valuable files from a computer to the ShareCenter Pulse manually, according to a schedule, or in real-time. Real-time backups are a great way to safeguard against unforeseen data-loss.

YOUR NETWORK SETUP

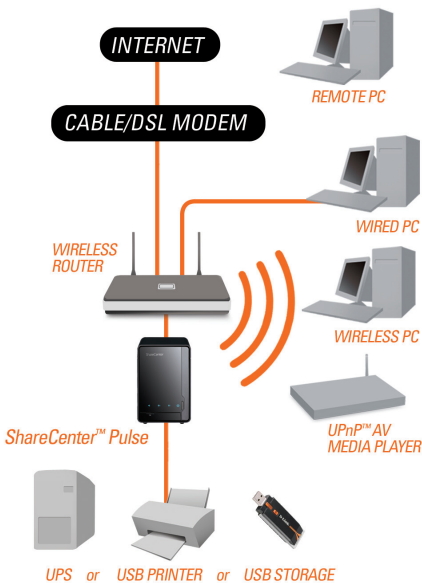

MIRRORING HARD DRIVES WITH RAID 1 TECHNOLOGY

Backing up to a regular hard drive offers a basic level of protection. But what if that hard drive fails? Using the ShareCenter Pulse with two internal SATA drives and RAID 1 technology, users can mirror the two drives (i.e. duplicate data on both drives), ensuring maximum protection of valuable data. If one drive fails, the other continues to function as a single drive until the failed drive is replaced.

D-LINK GREEN™

For consumers interested in reducing their energy costs and helping to save the environment, D-Link Green™ products provide eco-friendly alternatives without compromising performance. This device uses hard drive power management and Smart Fan speed control to reduce energy costs, minimize noise, and prolong the lifespan of your hard drives.

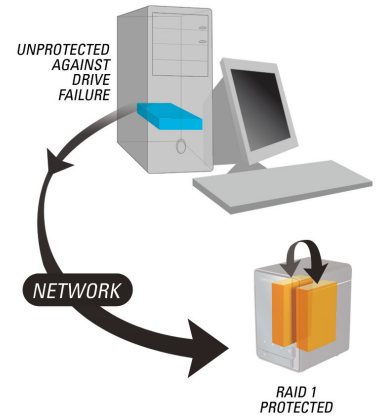

TECHNICAL SPECIFICATIONS

STANDARDS

- IEEE 802.3
- IEEE 802.3ab
- IEEE 802.3u
- TCP/IP
- CIFS/SMB
- NFS
- AFP
- DHCP Client
- DDNS
- NTP
- FTP over SSL/TLS, FXP
- HTTP/HTTPS
- LLTD
- PnP -X
- UPnP AV
- USB 2.0
- Bonjour

LEDS

- Power
- LAN
- HDD 1
- HDD 2

PORTS

- 10/100/1000 Gigabit Ethernet Port
- 1 USB 2.0 Port
- Power

SUPPORTED HARD DRIVE TYPE

- 3.5" Internal SATA (Maximum HDD Capacity: 2 TB for each drive)³

DISK MANAGEMENT¹

- Multiple Hard Drive Configurations: RAID 0, RAID 1, JBOD, Standard
- RAID migration from Non-RAID to RAID 1
- Hard Drive Format: EXT3
- Scandisk
- S.M.A.R.T.

DEVICE MANAGEMENT

- Internet Explorer 7, Mozilla Firefox 3+ or Apple Safari 4
- Easy Search Utility
- E-Mail Alerts
- System/FTP log
- Yahoo! Widget

FILE SHARING

- Max. User Accounts: 64
- Max. Groups: 10
- Max. Shared Folders: Without BT: 64
- Max. Concurrent Connections: Samba: 64

POWER SUPPLY

- External Power Supply
- DC 12V / 4A Switching

POWER CONSUMPTION

- Normal mode: 15.7 W
- Sleep mode: 8.2 W

TEMPERATURE

- Operating: 0° to 40° C (32° to 104° F)
- Storage: -20° to 70° C (-4° to 158° F)

OPERATING HUMIDITY

- 5% to 90% (Non-condensing)

DIMENSIONS (L x W x H)

- 146.4 x 115 x 178.5 mm (5.8 x 4.5 x 7.0 inches)

WEIGHT

- 0.85 kg (1.87 lbs)

MULTILINGUAL SUPPORT

- Samba: Unicode
- FTP Client: Unicode, Korean, Turkish, Croatian, Cyrillic (Kyrgyz Republic), Czech, Danish, Dutch, English, Finnish, French, German, Greek, Hungarian, Italian, Norwegian, Polish, Portuguese, Romanian, Russian, Simplified Chinese, Slovenian, Spanish, Swedish, Traditional Chinese, Turkish, Korean, Hebrew

¹ Hard drives not included. RAID 1 mirroring requires the use of two internal sata drives. To avoid data incompatibility in RAID 1 operation, use SATA drives from the same manufacturer. Formatted drive capacity for RAID 1 operation is dependant on the drive capacity of the lowest-sized drive. May not work with older generation SATA drives. For a list of SATA drives that have been tested to work with the ShareCenter Pulse, visit D-Link support websites.

² D-Link cannot guarantee full compatibility or proper playback with all codecs. Playback capability depends on the codec support of the UPnP AV media player.

³ Maximum HDD capacity supported may increase in future depending on advances in SATA technology.



D-Link Corporation
No. 289 Xinhu 3rd Road, Neihu, Taipei 114, Taiwan
Specifications are subject to change without notice.
D-Link is a registered trademark of D-Link Corporation and its overseas subsidiaries.
All other trademarks belong to their respective owners.
©2010 D-Link Corporation. All rights reserved.
Release 01 (September 2010)